

The POETICS of GARDENS

CHARLES W. MOORE

WILLIAM J. MITCHELL

WILLIAM TURNBULL, JR.

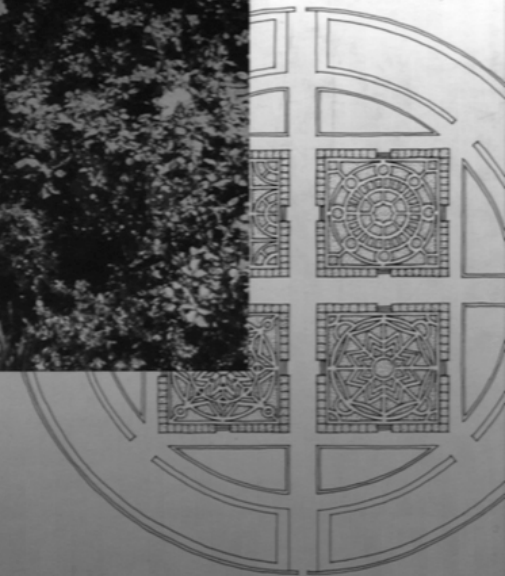

Laboratorio di architettura dei giardini e del paesaggio
A.A. 2016\17



The Sea Ranch, Sonoma, CA con. Lawrence Halprin





© DAM UND CHARLES MOORE \ FOTO: HAGEN STIER

Piazza d'Italia, New Orleans, 1978



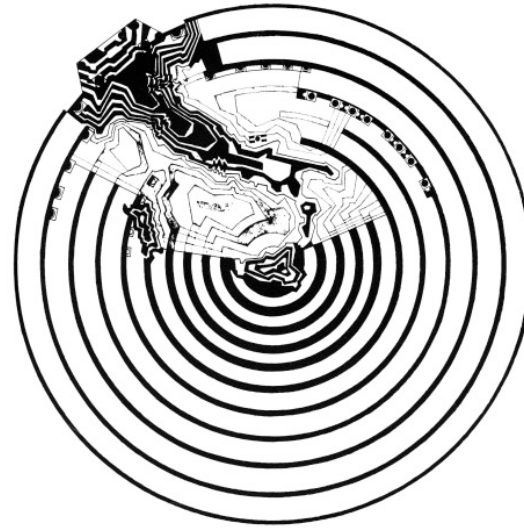

CHARLES MOORE – **PIAZZA D'ITALIA**

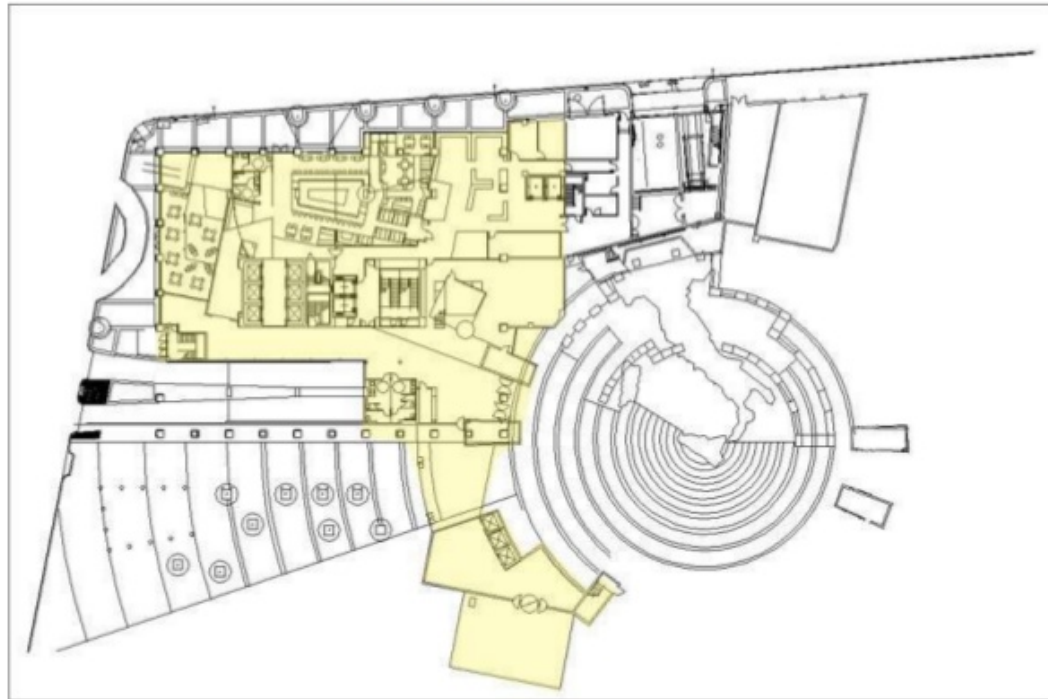

Image Source: http://www.dustinlike.com/wp-content/uploads/2012/07/in_hotel_plan_ig.jpg (On line)

New Orleans, 1978





SITE PLAN

0 25 50 100

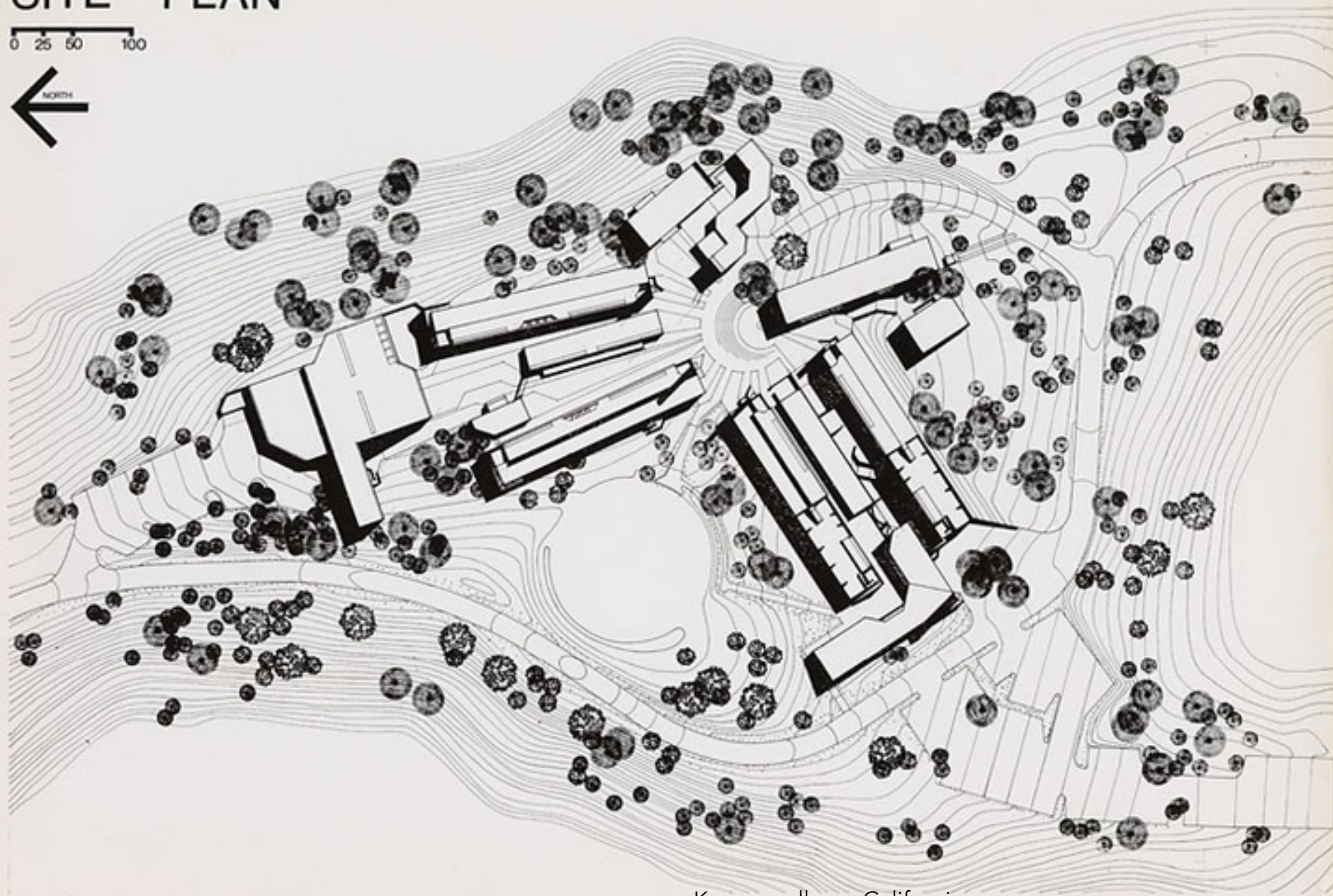

Kresge college, California

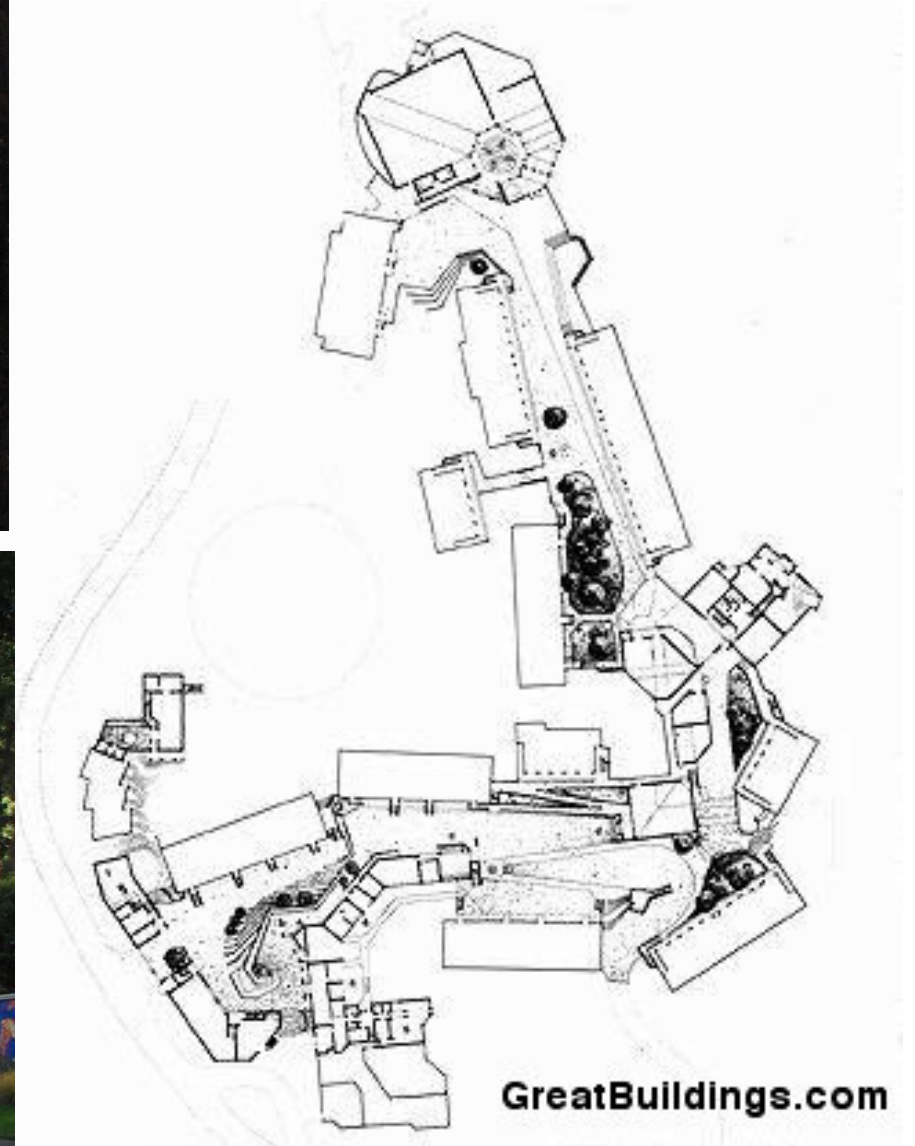



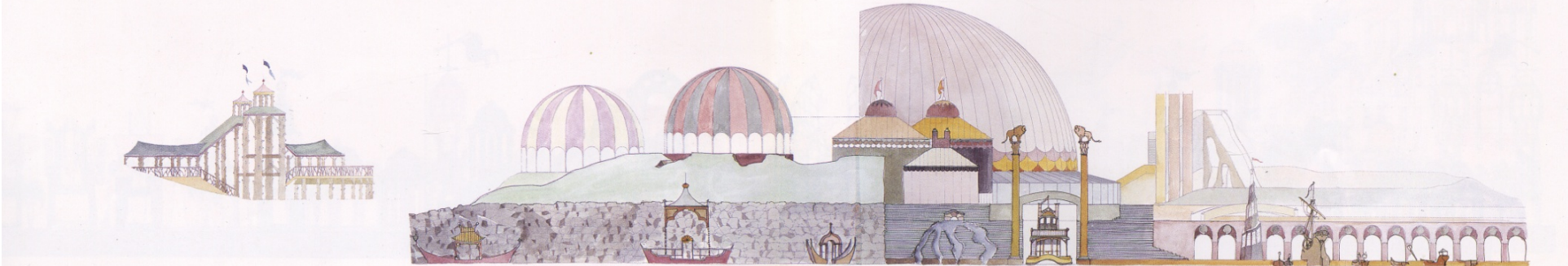
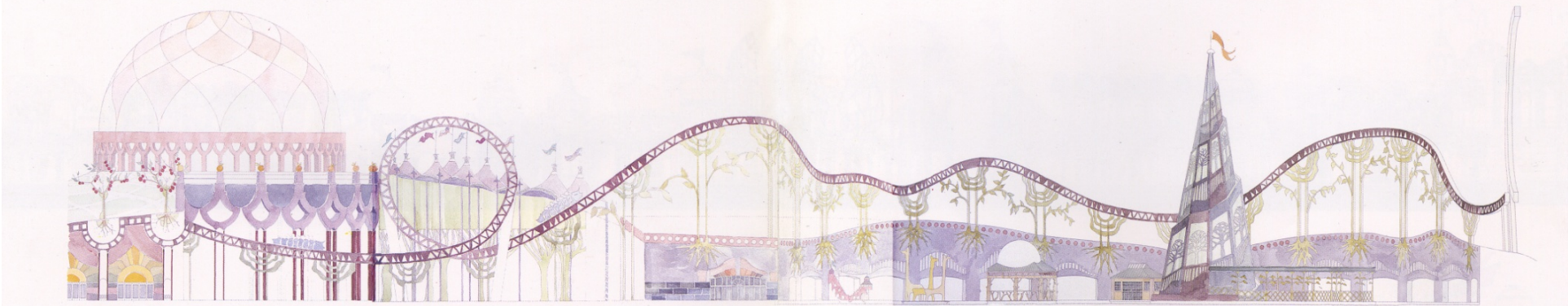

37. **Wonderwall 1982-1984** *Dismantled*
New Orleans, Louisiana
World's Fair
Charles W. Moore and William Turnbull
with August Perez Associates, Kent Bloomer,
Leonard Salvato, and Arthur Andersson
and Urban Innovations Group

- 1. Elevation
Ink and watercolor on paper, 18" x 116"
- 2. Elevation
Ink and watercolor on paper, 18" x 116"
- 3. Elevation
Ink and watercolor on paper, 18" x 116"



37. **Wonderwall 1982–1984** *Dismantled*

New Orleans, Louisiana
World's Fair
Charles W. Moore and William Turnbull
with August Perez Associates, Kent Bloomer,
Leonard Salvato, and Arthur Andersson
and Urban Innovations Group

1. Elevation
Ink and watercolor on paper, 18" × 116"

2. Elevation
Ink and watercolor on paper, 18" × 116"

3. Elevation
Ink and watercolor on paper, 18" × 116"

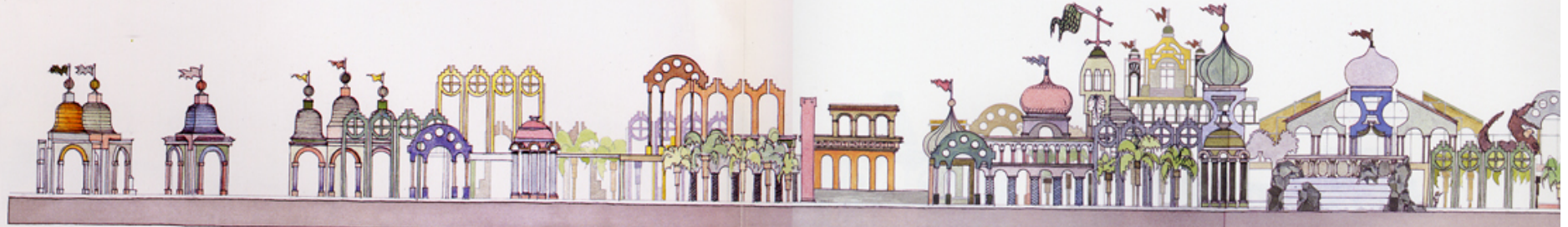







4. *The Spaniards Introduce Palm Trees to Catalina Island, 1985*
Ink and watercolor on paper
Drawing by Charles W. Moore



5. *Seaside*
Hand-colored lithograph, 7" x 5"
Drawing by Charles W. Moore

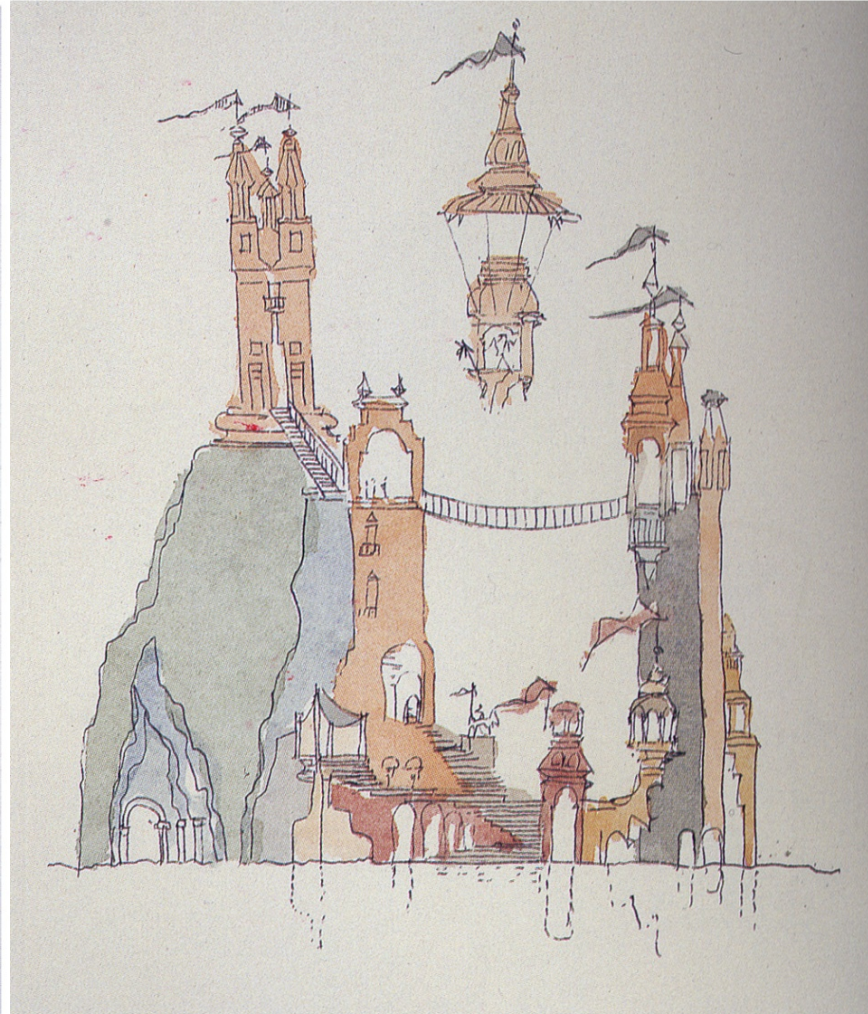

6. *Love to Mimi and Saul, Christmas 1981*
Ink and watercolor on paper
Drawing by Charles W. Moore
(Collection of Mrs. Saul Weingarten)



2. *Architectural history of Texas* (cover for *Center magazine*), 1985
Pencil, ink, and watercolor wash on paper,
12.25" × 9"
Drawing by Charles W. Moore

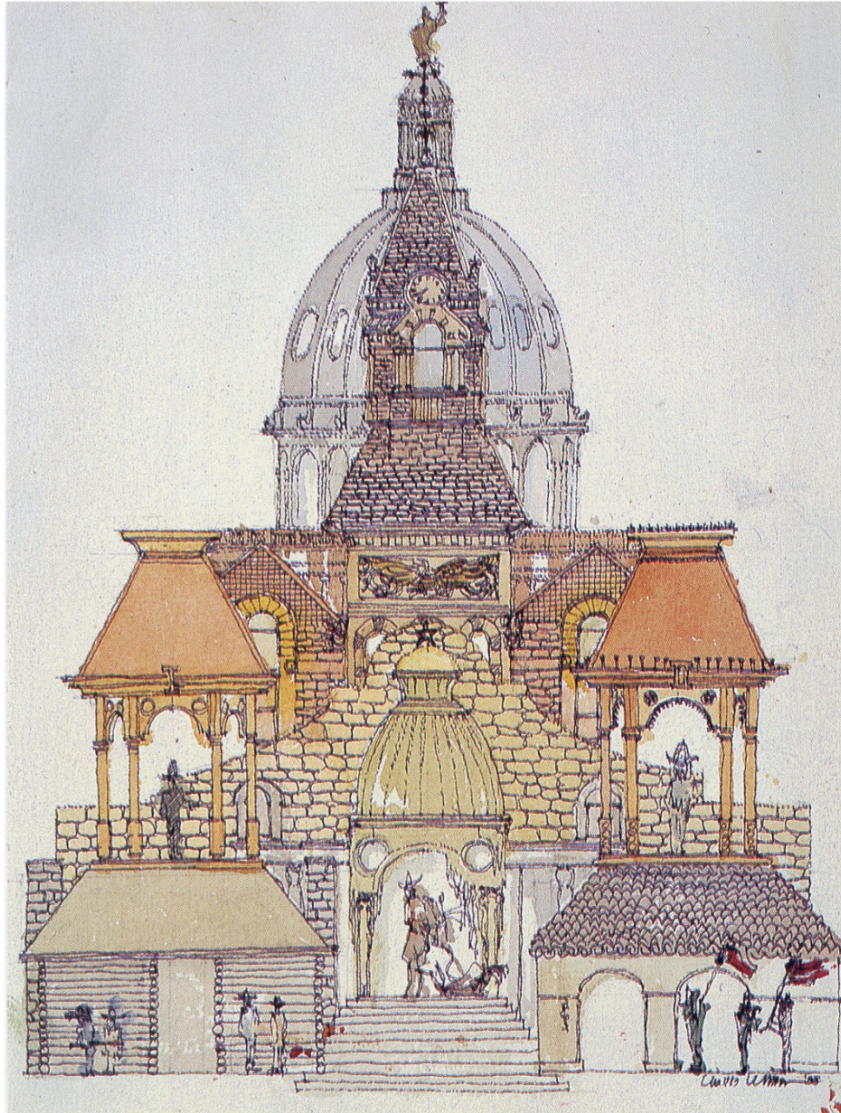

3. *Fantasy with towers*, 1984
Ink and watercolor on paper
Drawing by Charles W. Moore
(Collection of Mrs. Saul Weingarten)

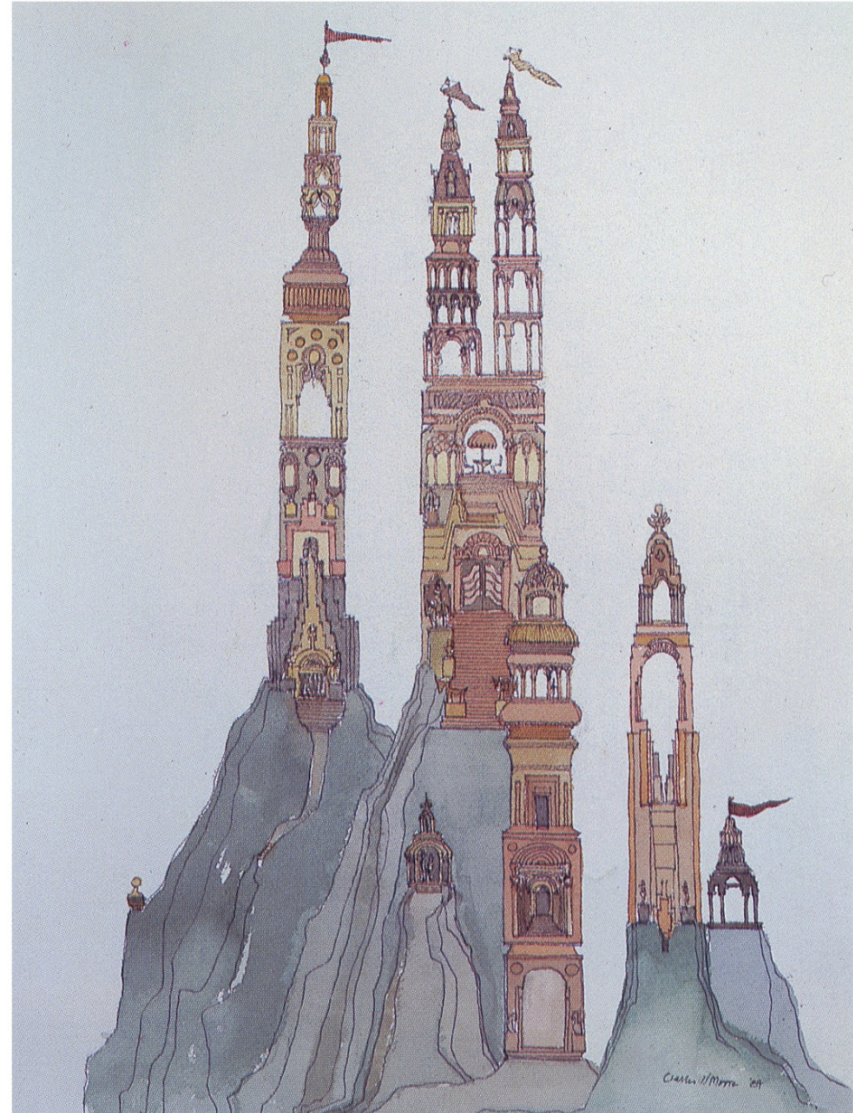

1. *Fantasy with floating and tethered barge, 1985*
Ink and watercolor on paper, 24" × 18"
Drawing by Charles W. Moore
(Collection of Mrs. Saul Weingarten)



9. Eight decorated Christmas cookies, assorted sizes, 1983
(Collection of Mrs. Saul Weingarten)



10. Seven decorated Christmas cookies, assorted sizes, 1983
(Collection of Mrs. Saul Weingarten)



The *yang* forms of land



Mountain

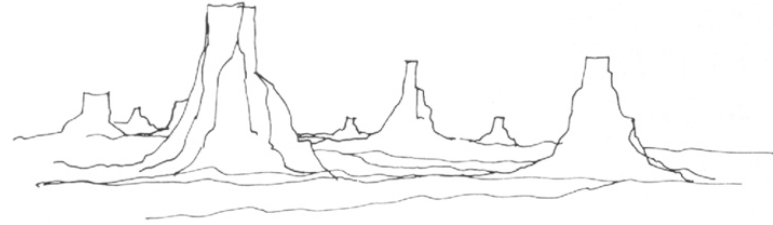

Buttes



Range



Cliffs

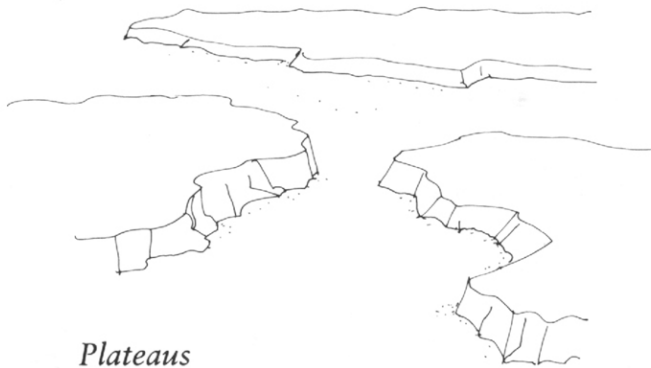

Plateaus



Hills



Rocks

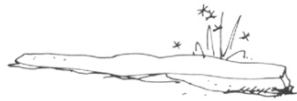

Valley



Ravine

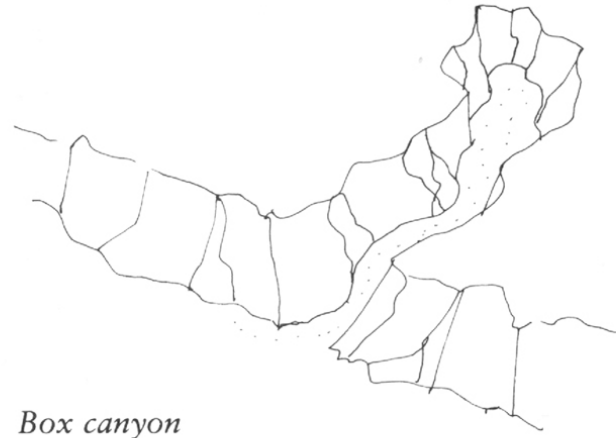

Box canyon



Cavern

The *yin* forms of water

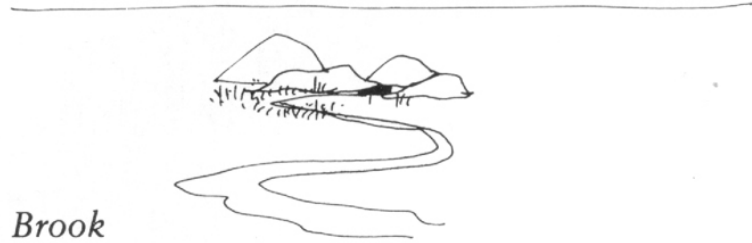

Brook



River

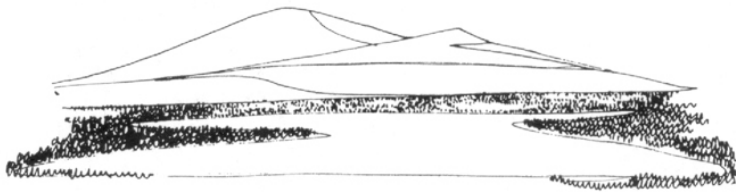

Lake

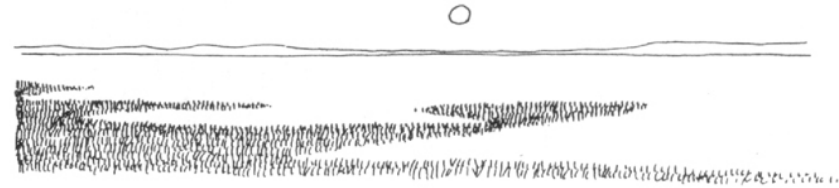

Marsh



Ocean

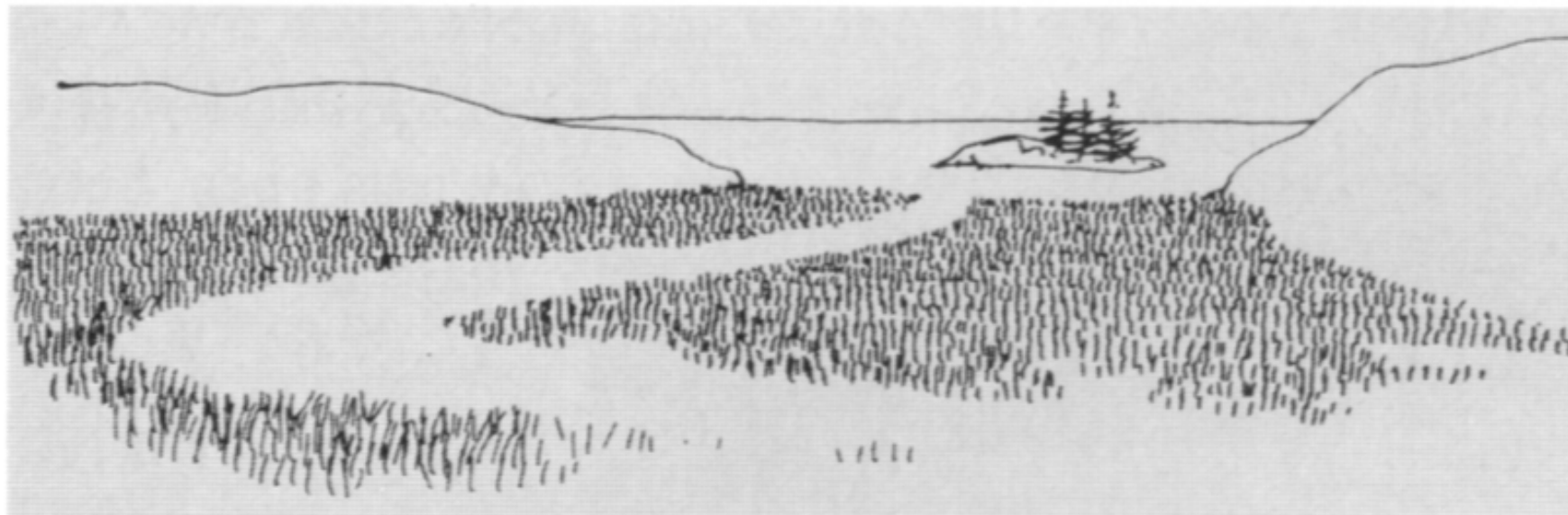
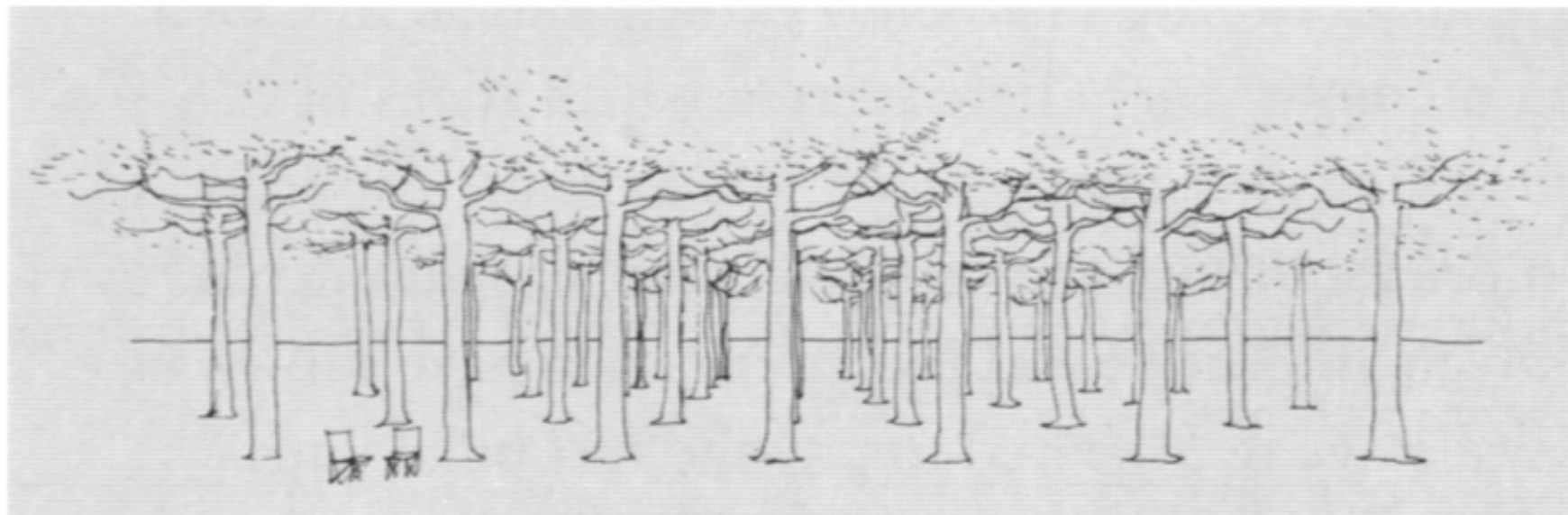



1. Gate
2. Pine tree
3. Mount of Maples
4. Sotetsu "mountain"
5. Rustic hut
6. Gorge (Oi River)
7. Cape with lantern
8. Amanohashidate
9. Shokin-tei
10. Valley of the Fireflies
11. Green Mountain Island
12. Shoka-tei
13. Orin-do
14. Shoi-ken
15. Lawn

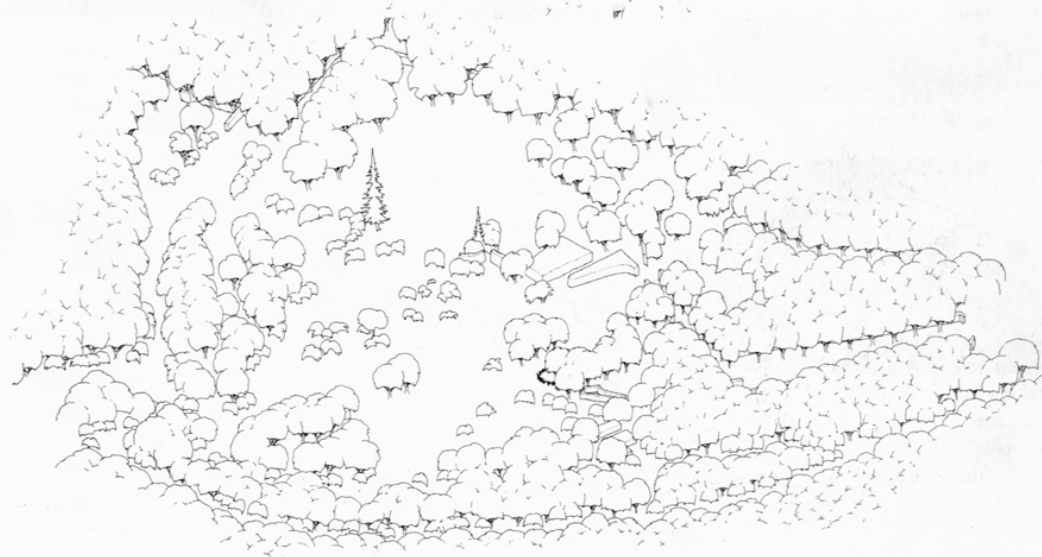
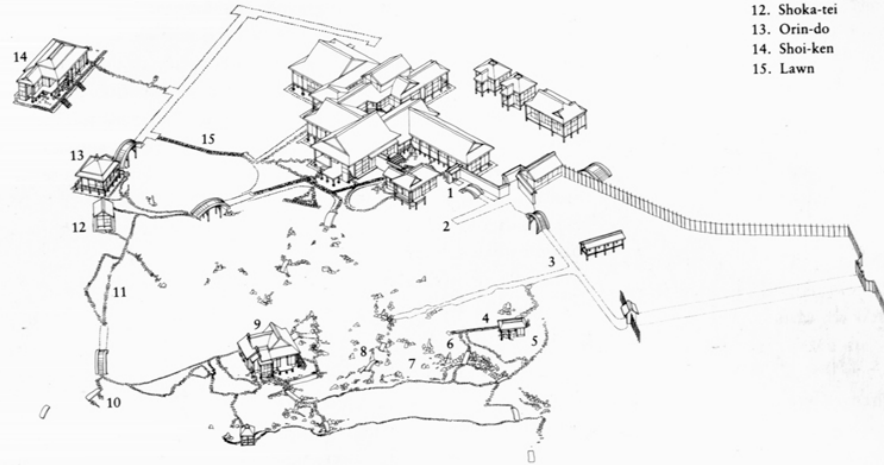

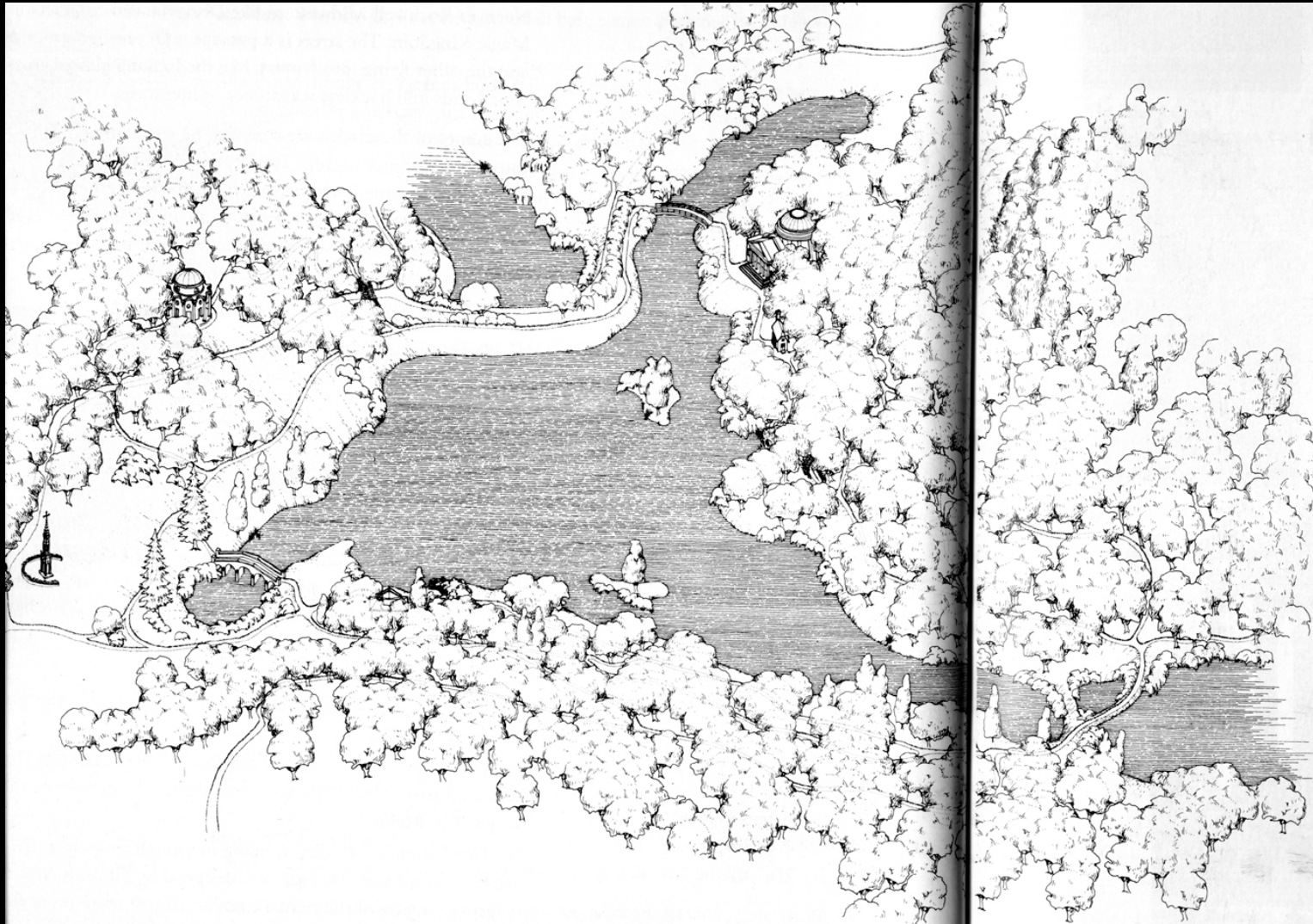

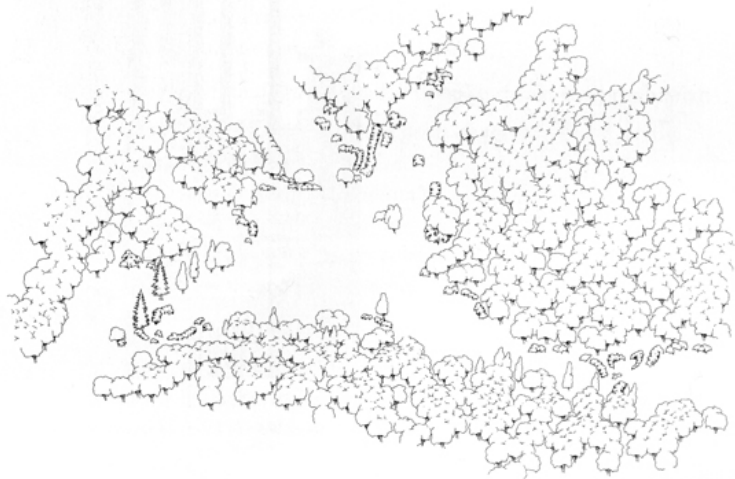
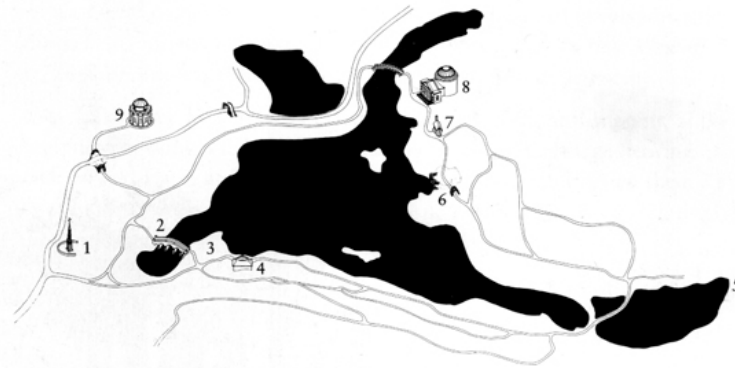
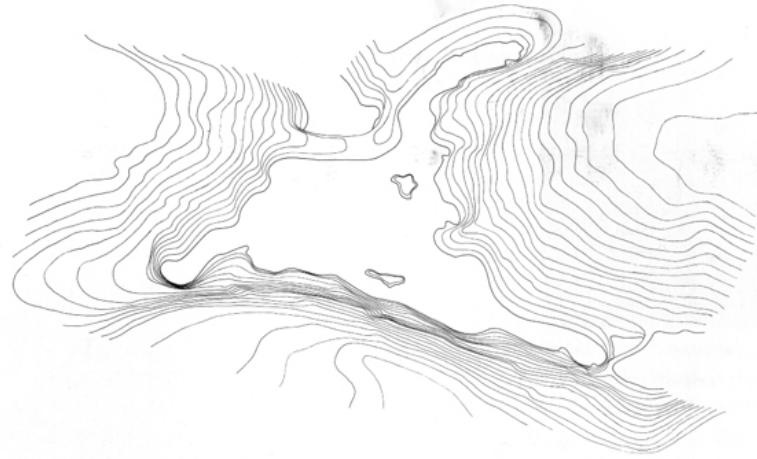

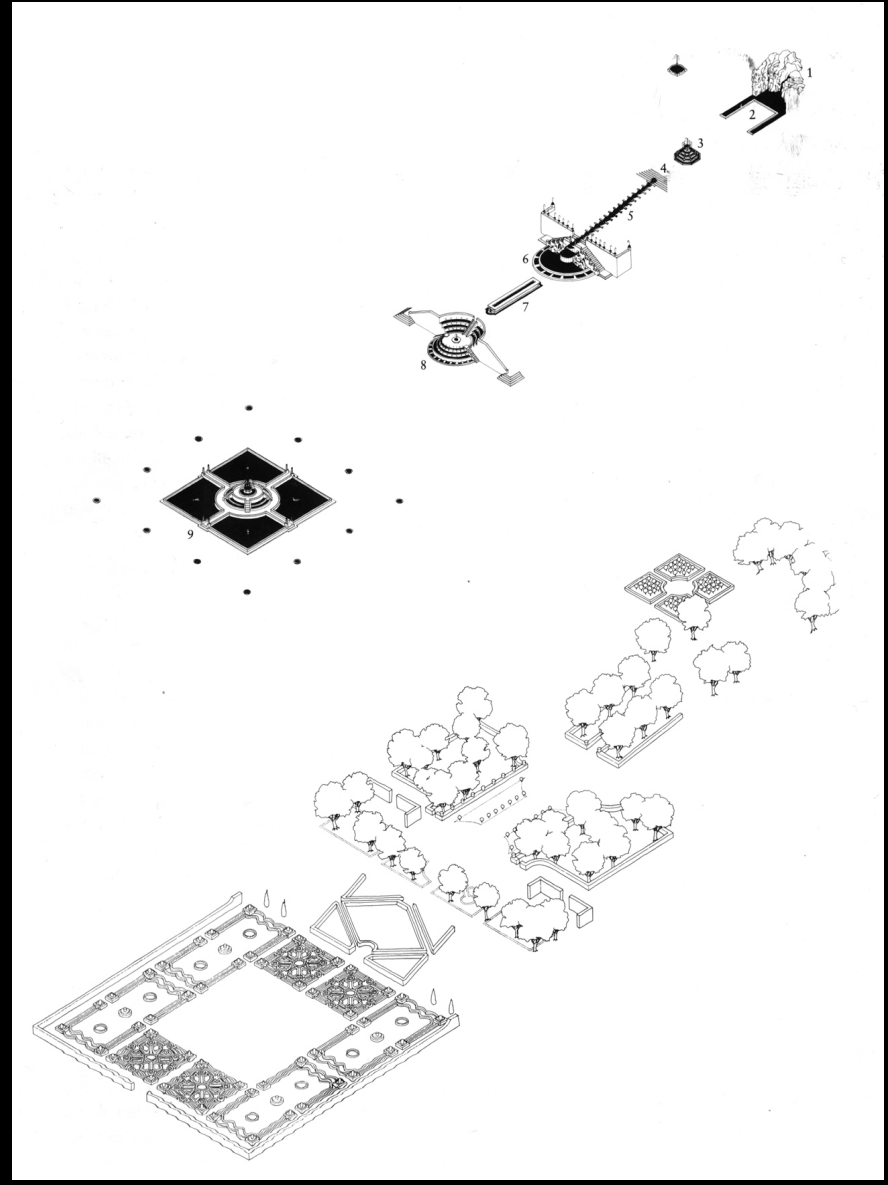
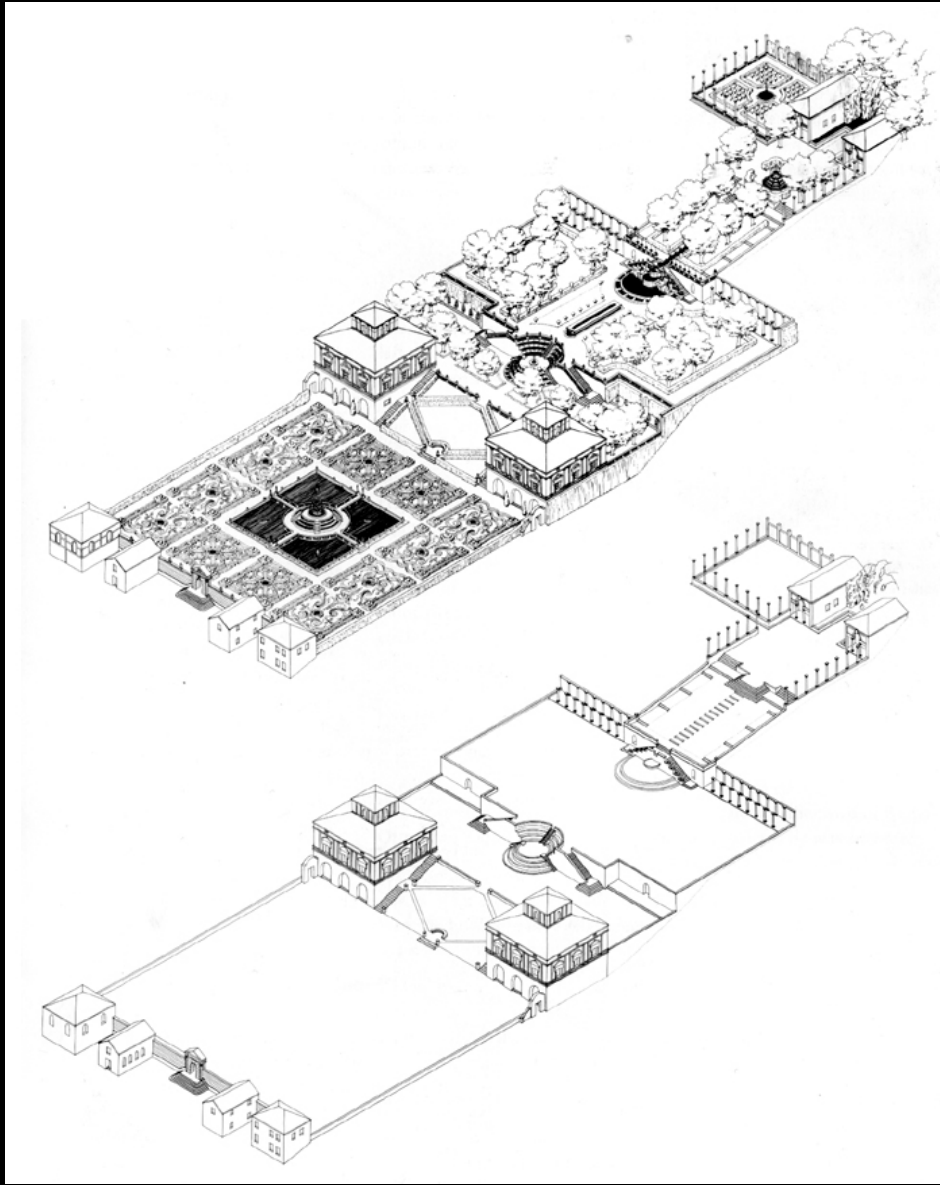

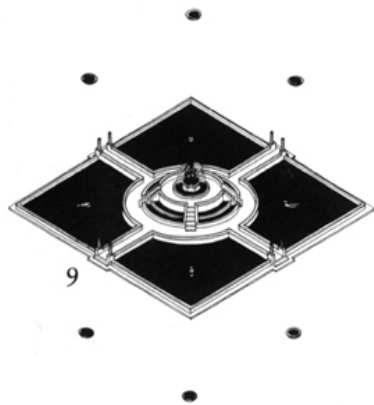
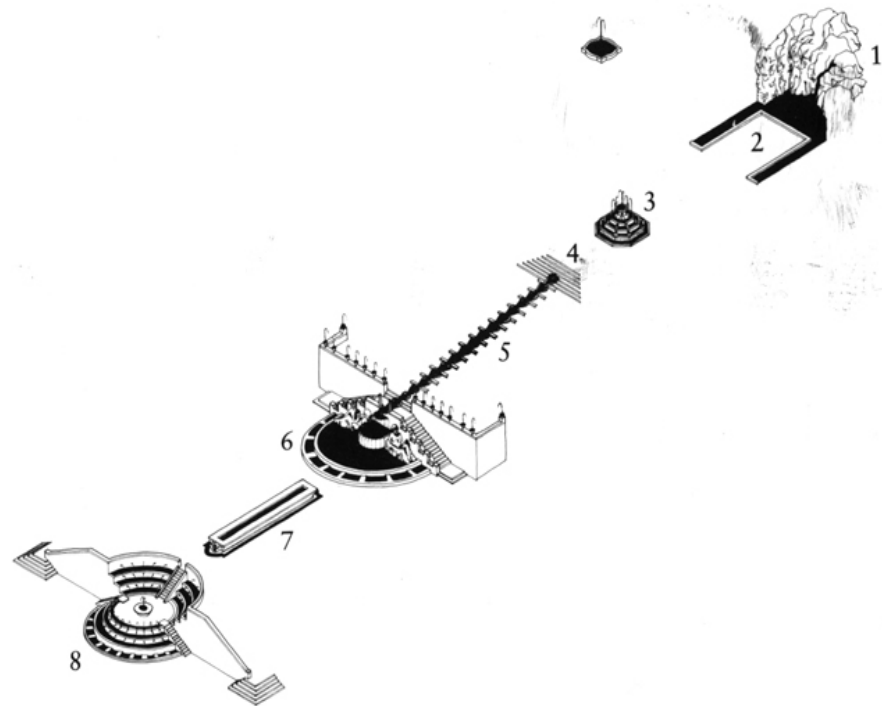

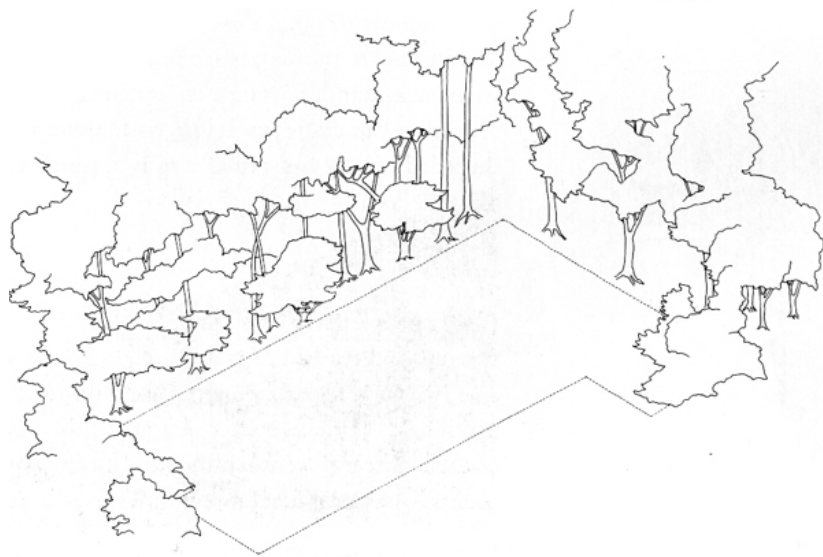
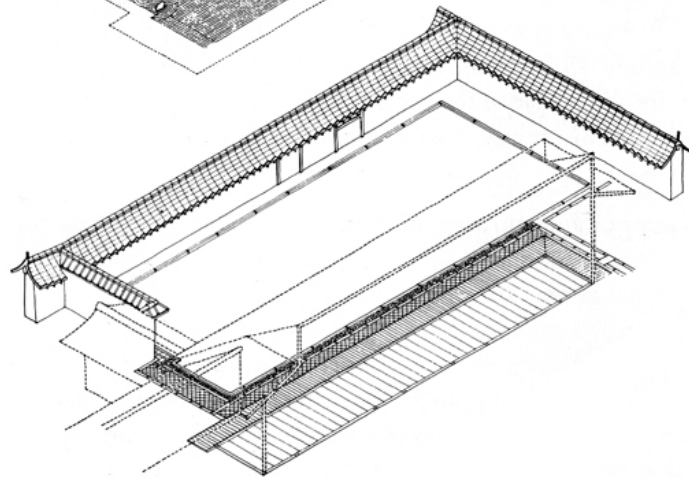
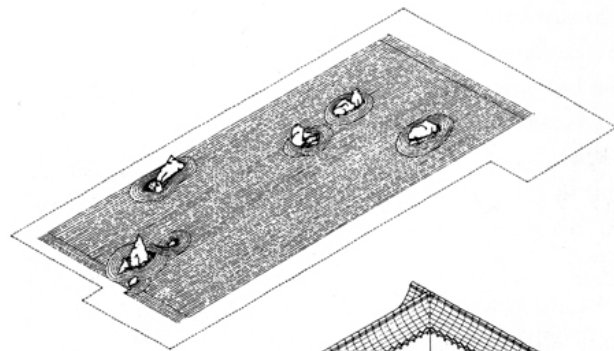
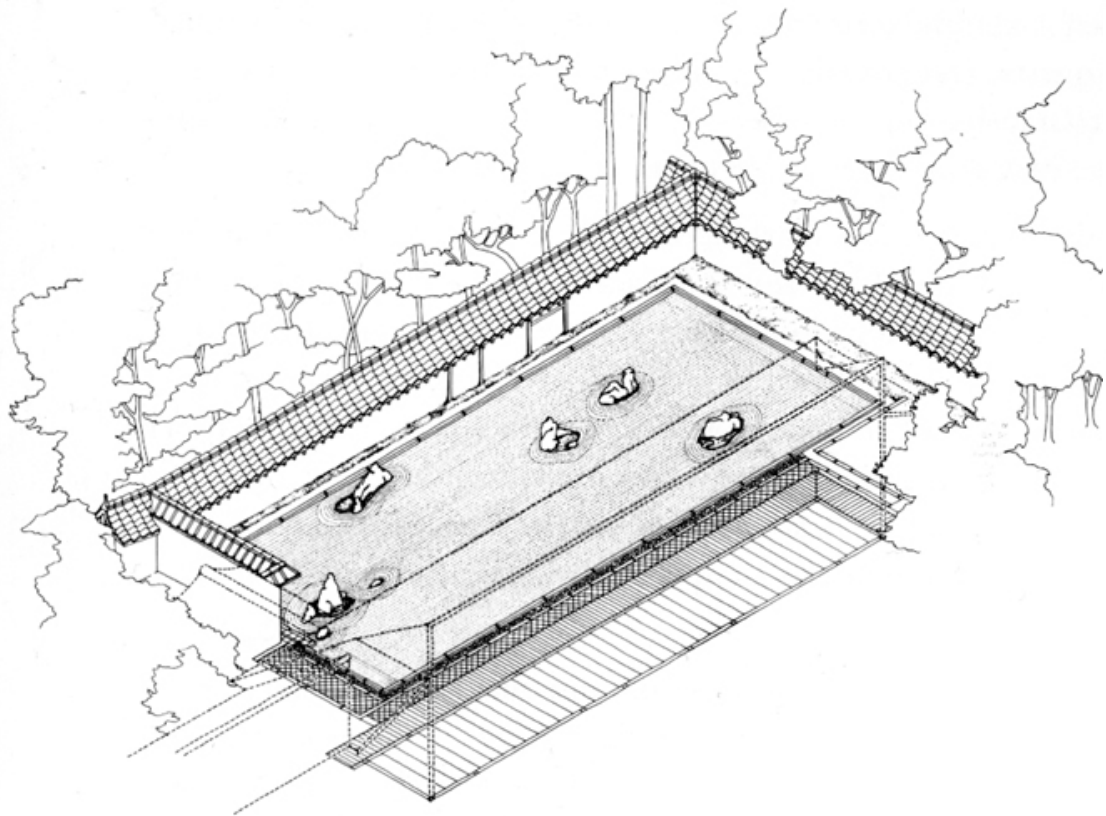

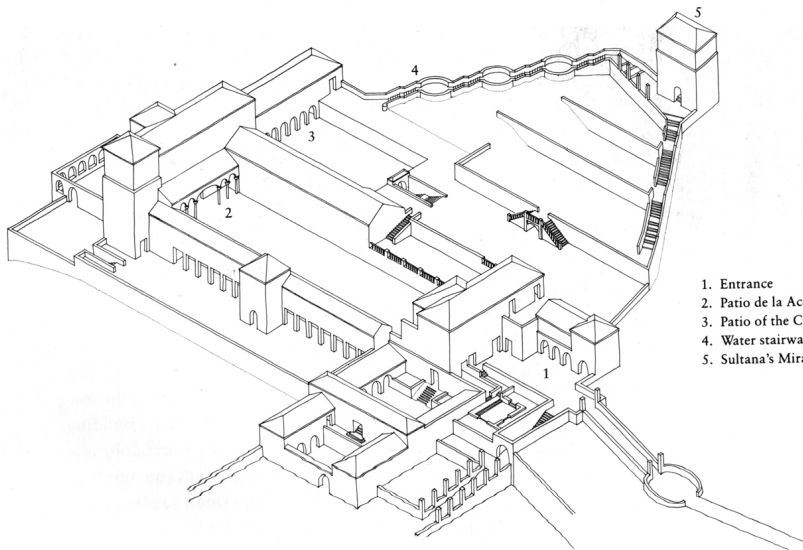
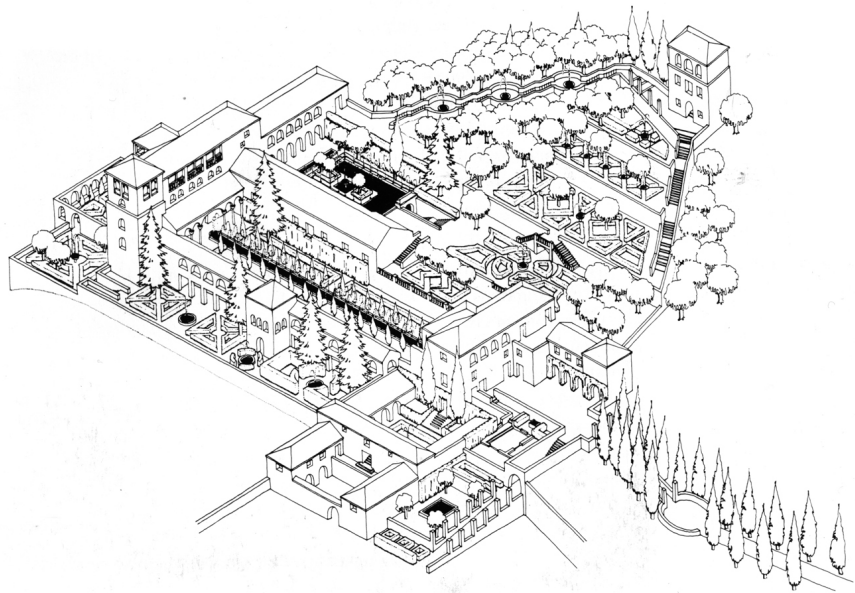

1. Entrance
2. Patio de la Acequia
3. Patio of the Cypresses
4. Water stairway
5. Sultana's Mirador

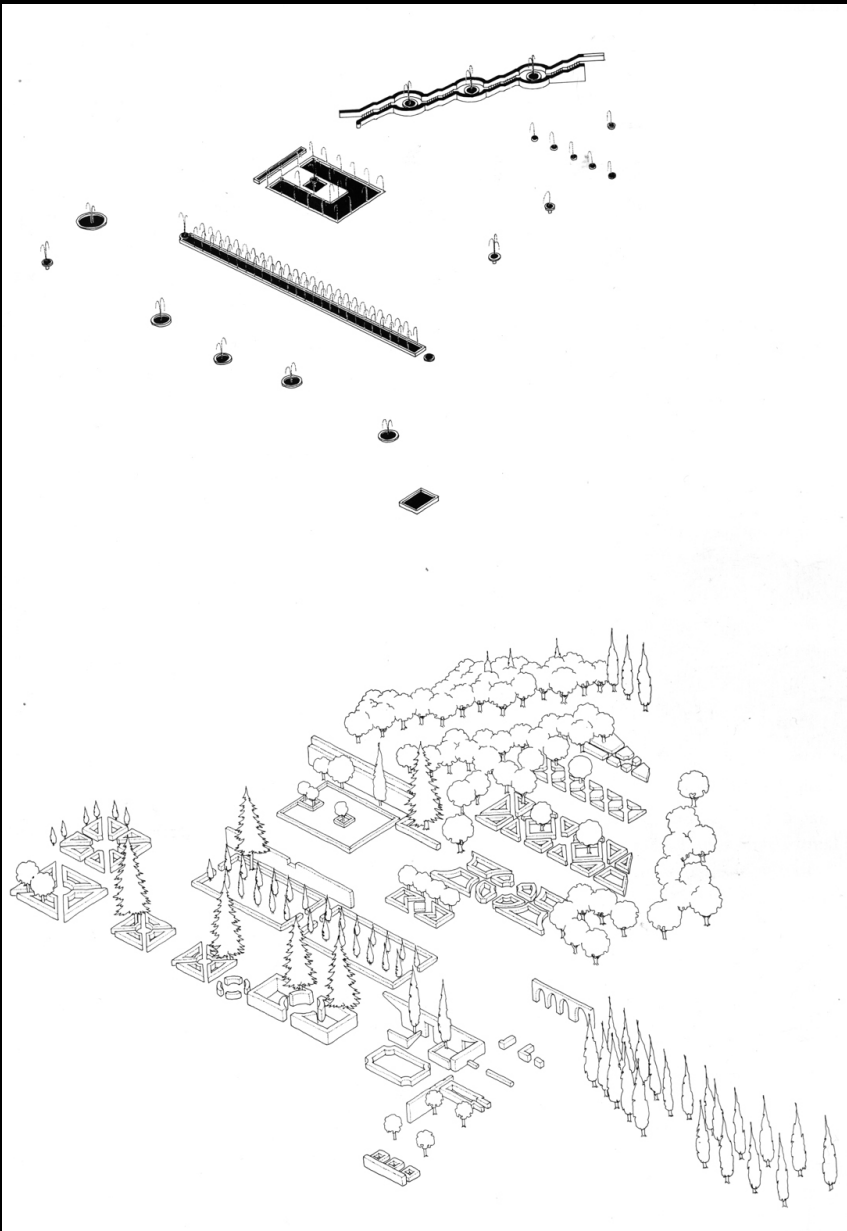

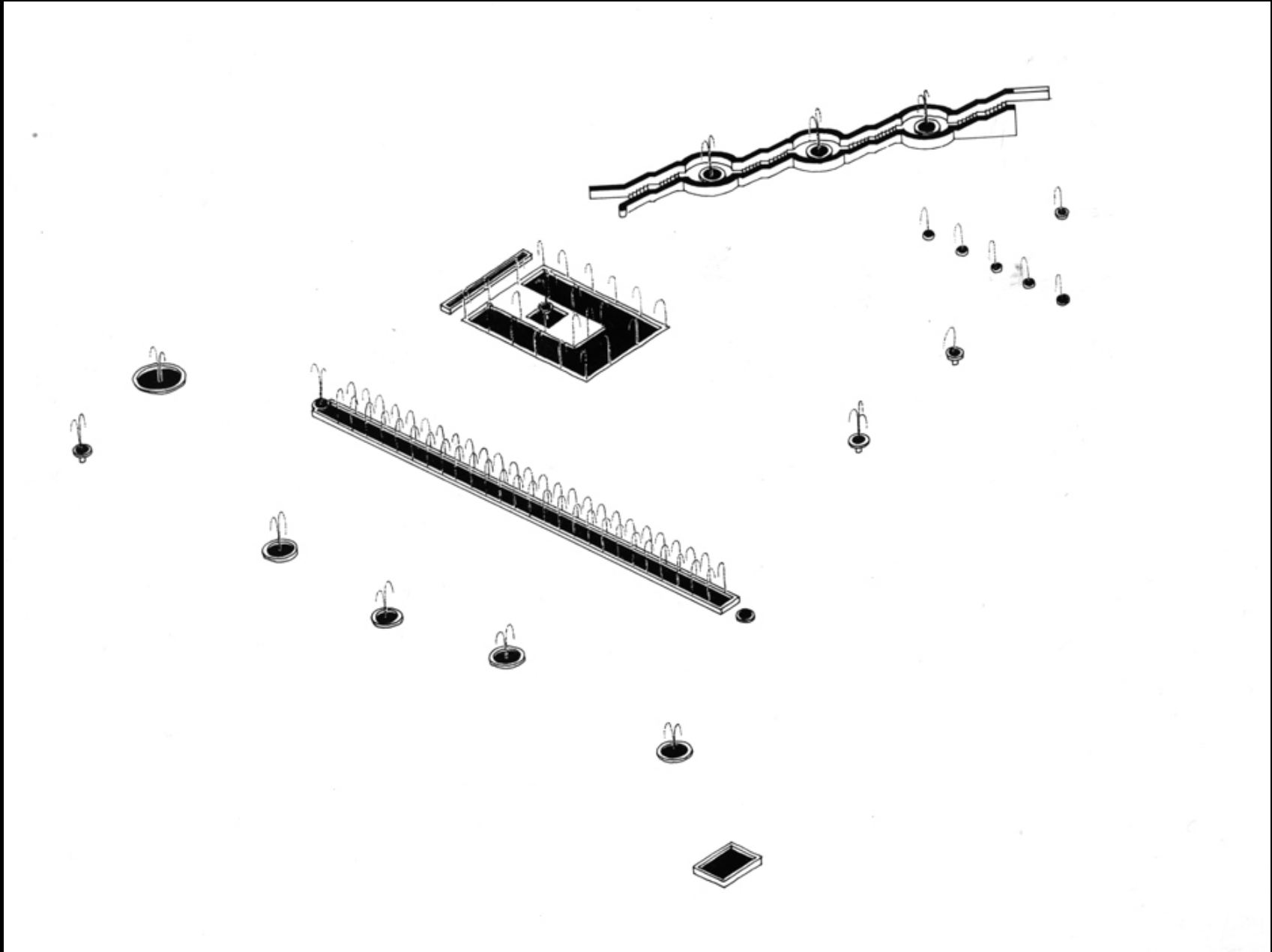



Mario Gandelsonas, *The urban text*, The MIT Press, Cambridge, 1991





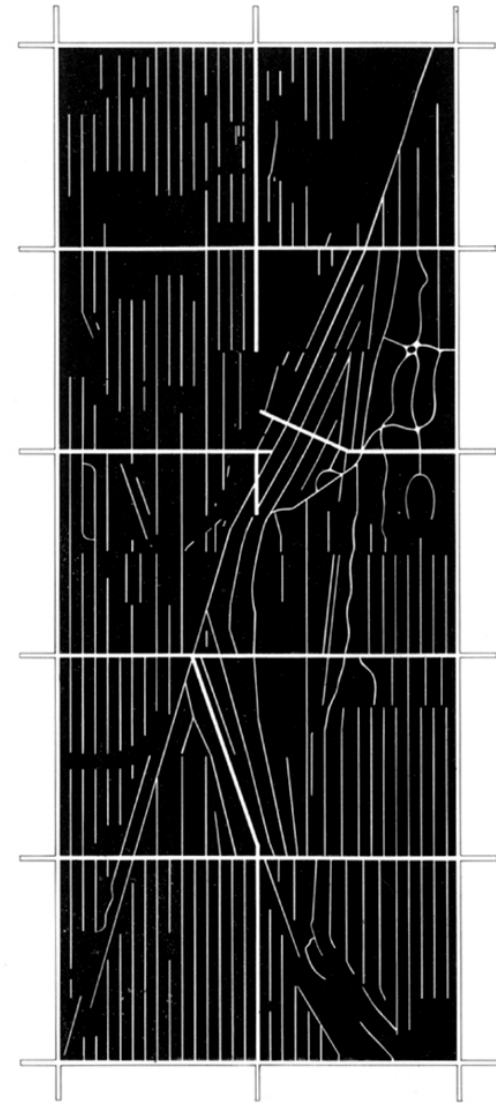
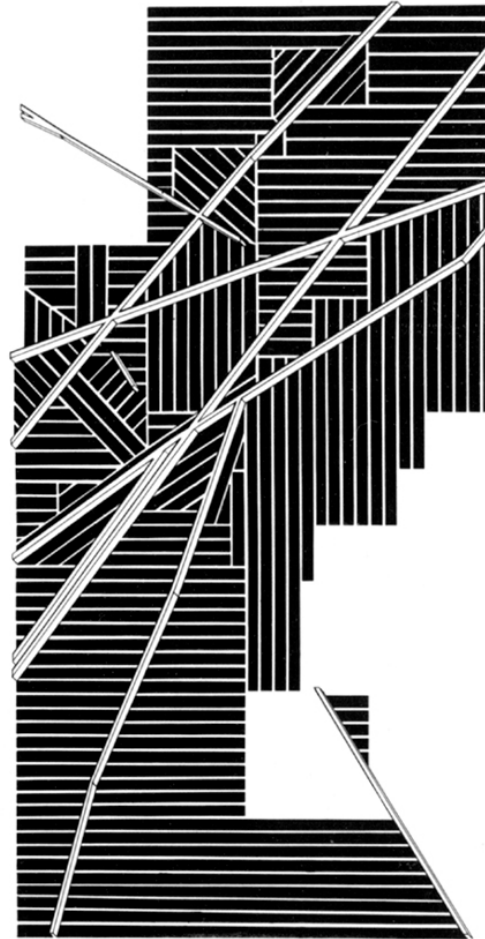
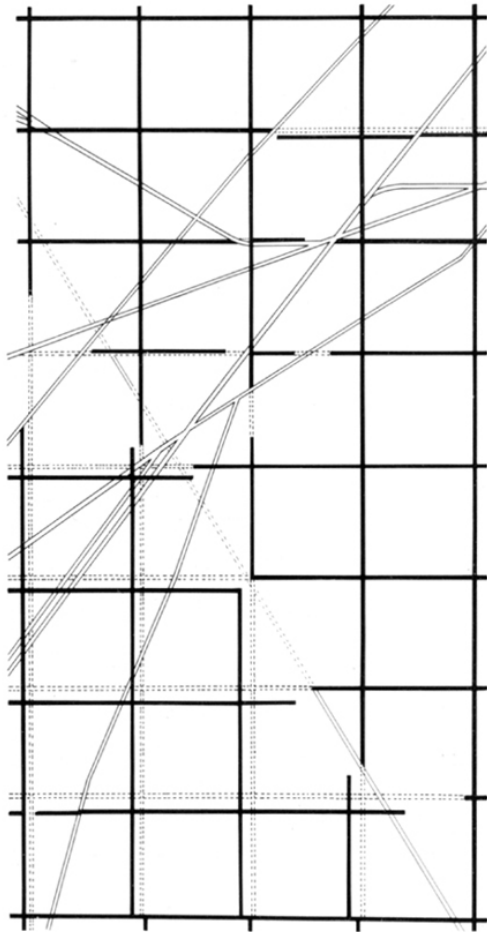

*Series of drawings investigating the collisions, overlapping and fragmentation of the grid of Chicago
Drawings by Brendan Fahey (left and center) and Julie Evans (above), School of Architecture, University of Illinois, Chicago*

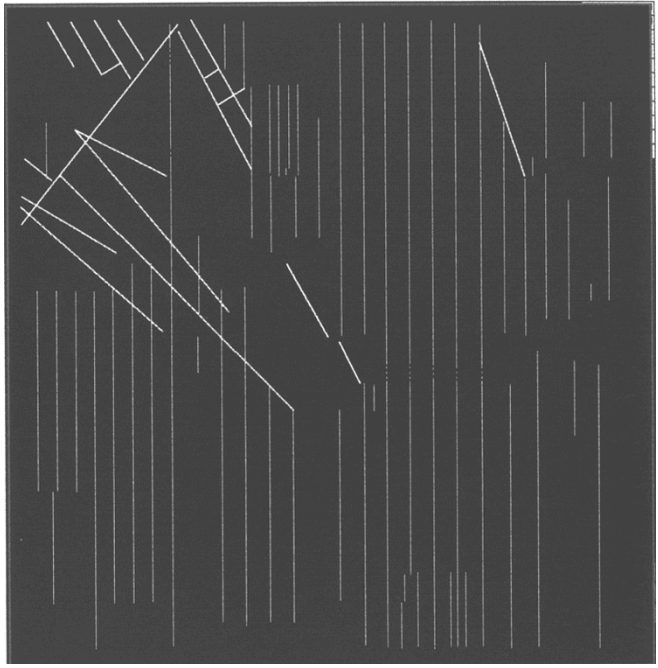
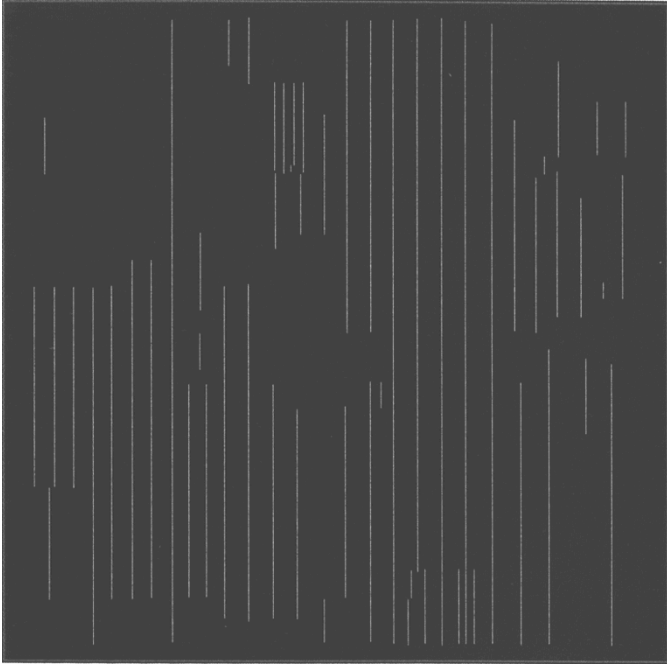
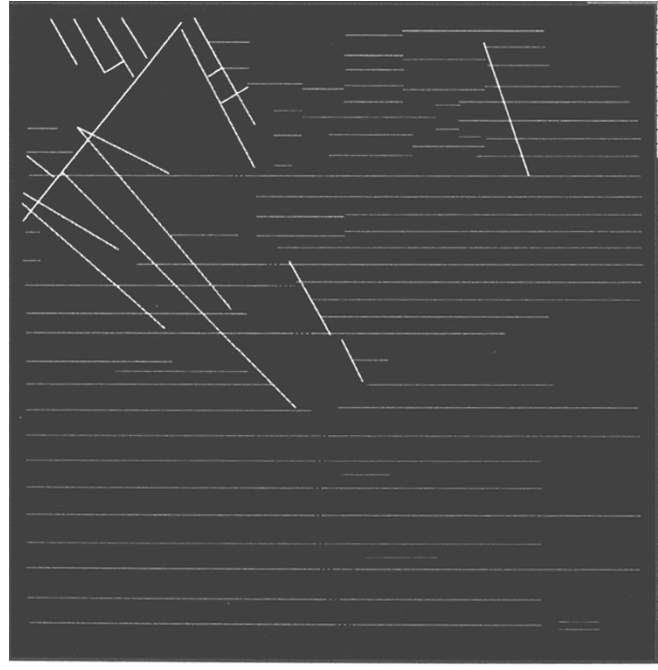



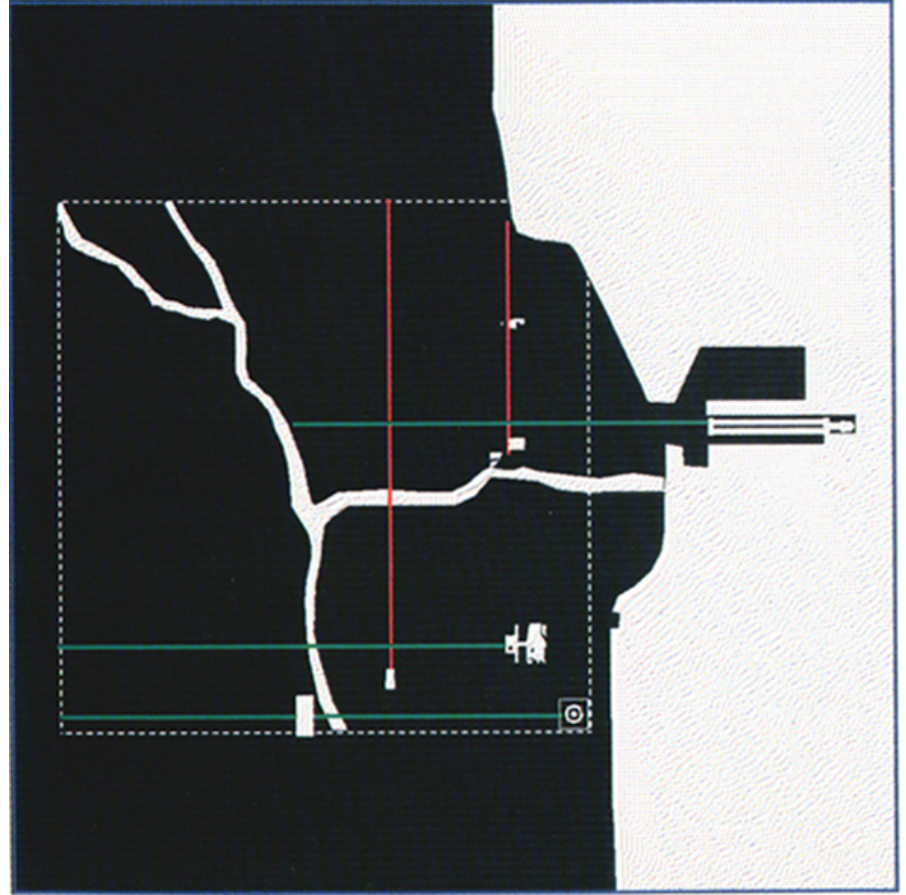
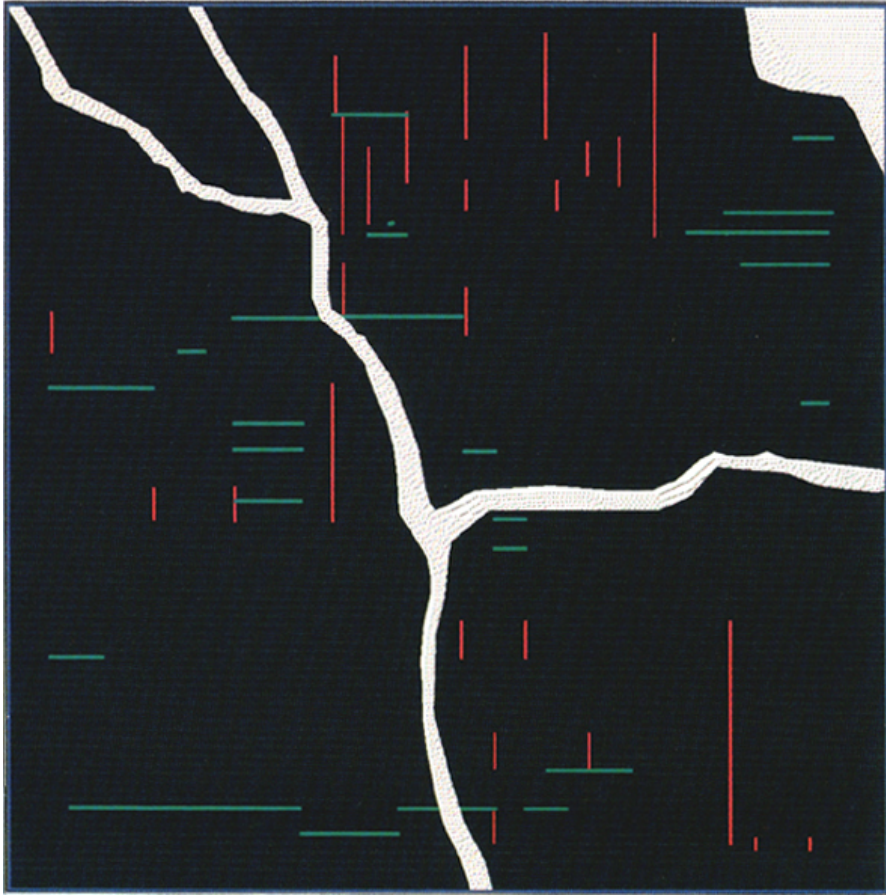

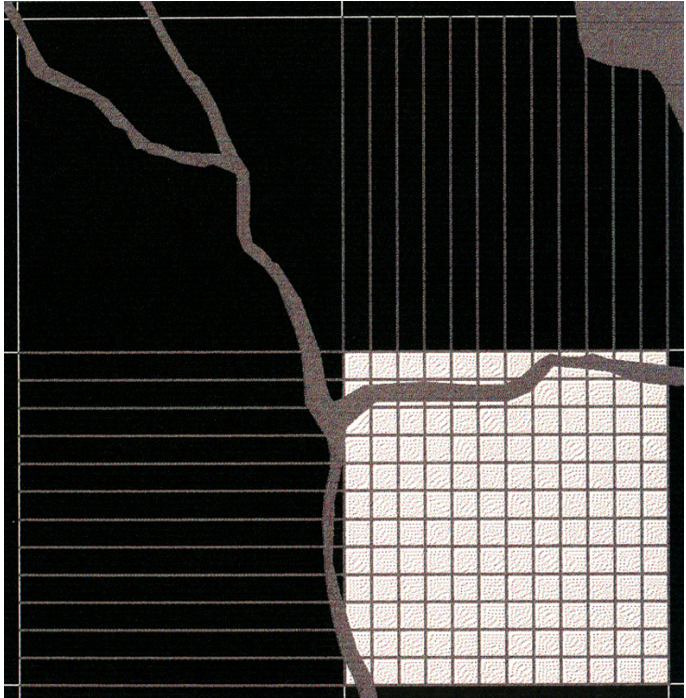

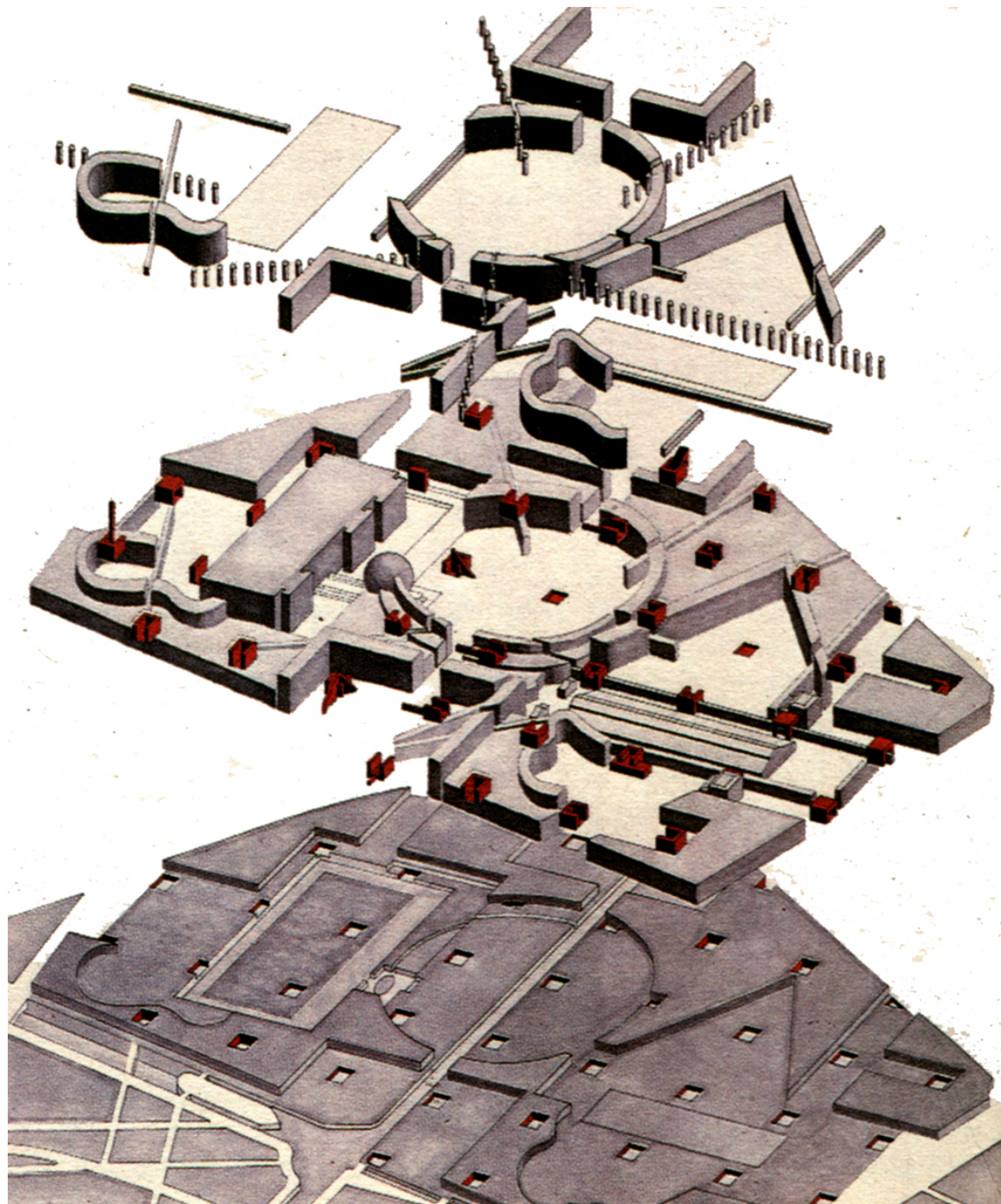

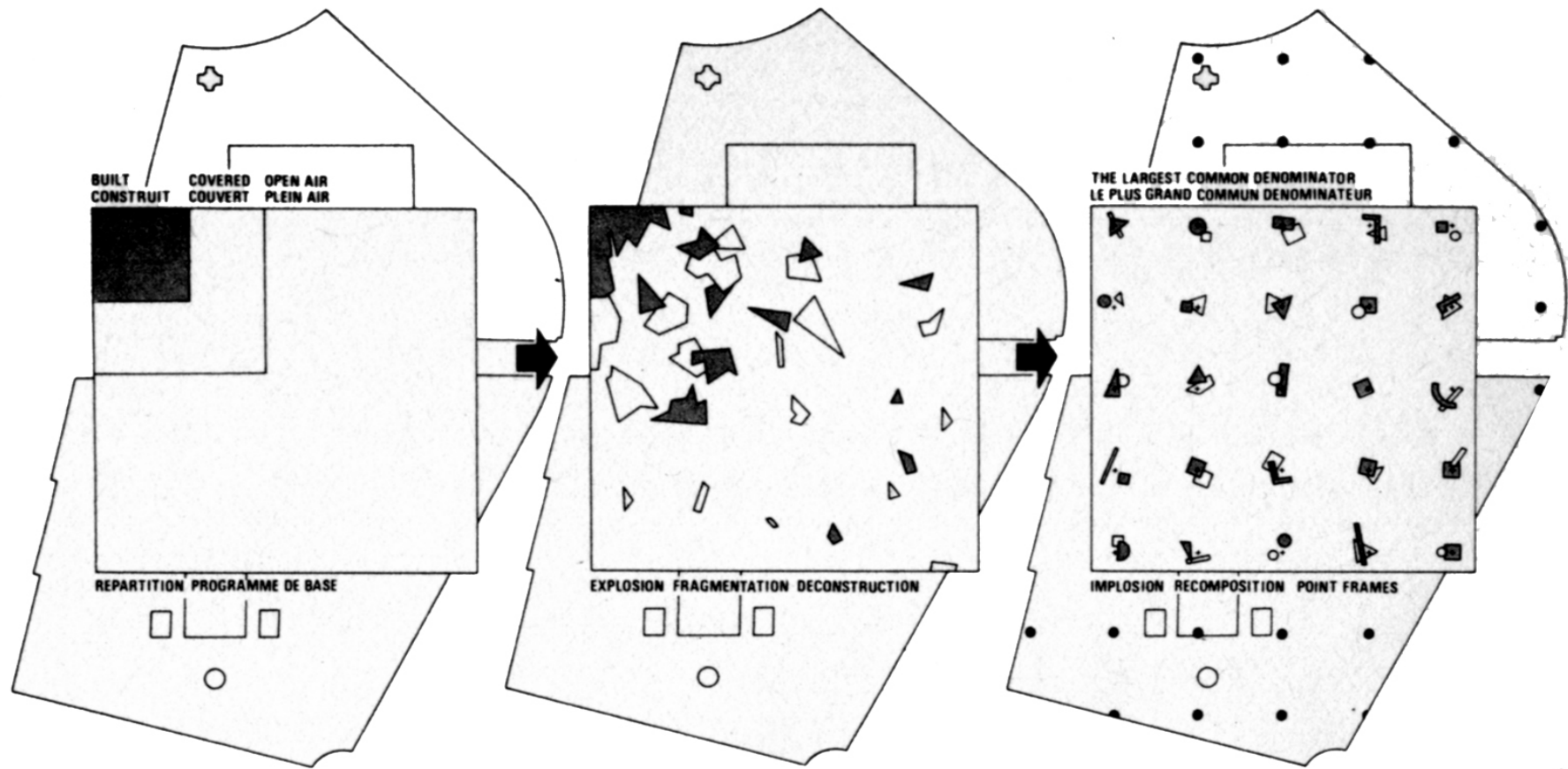

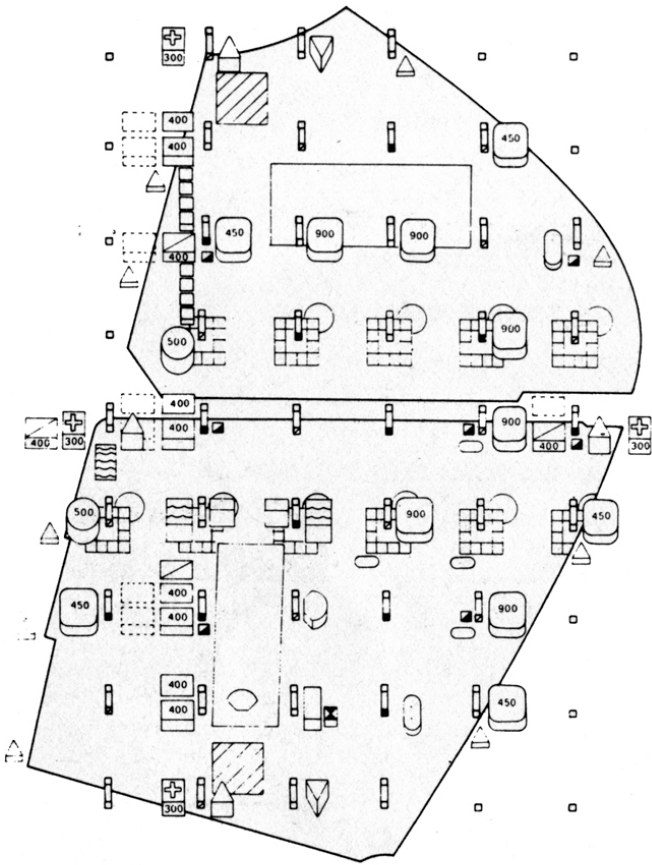

2

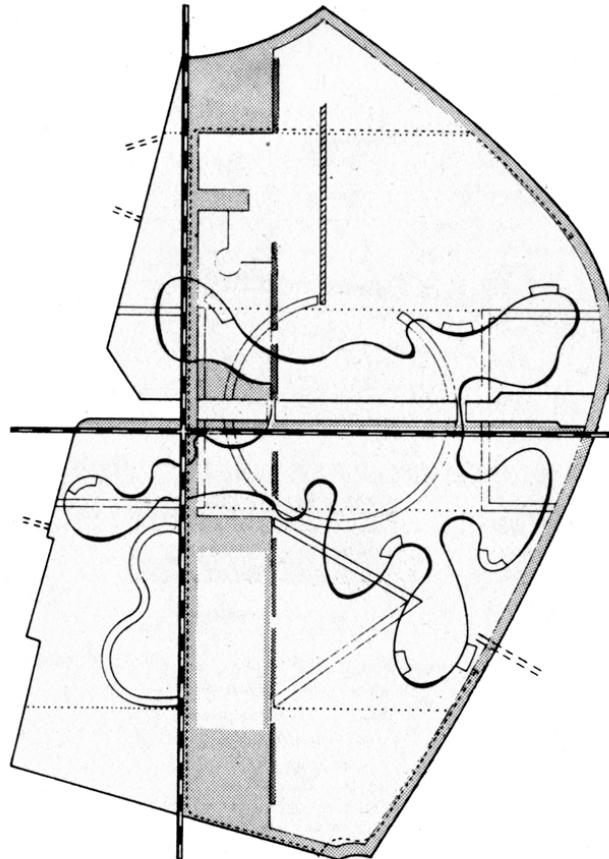

3

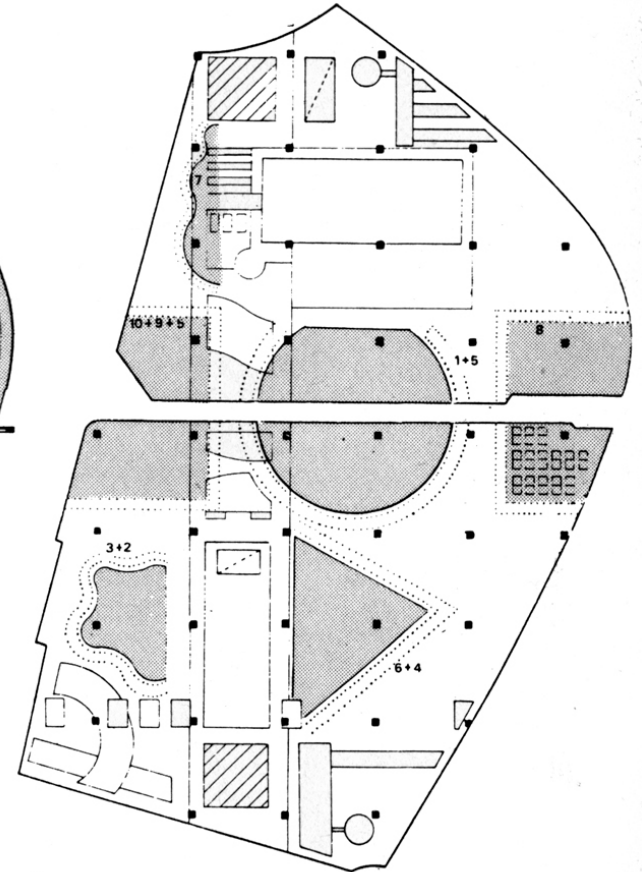

4

Rem Koolhaas, Parc de la Villette, planimetria generala.

Rem Koolhaas, Parc de la Villette, site plan.

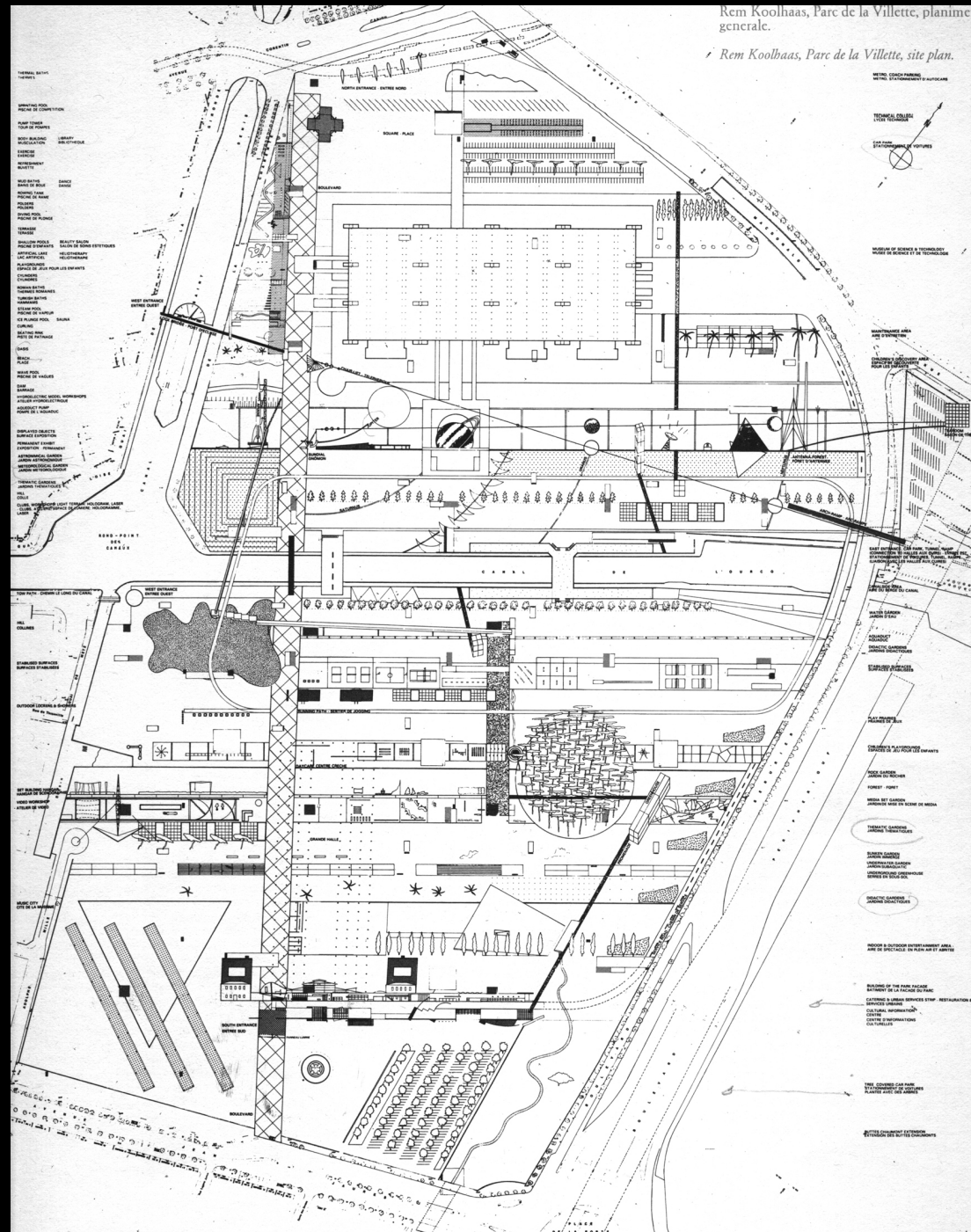

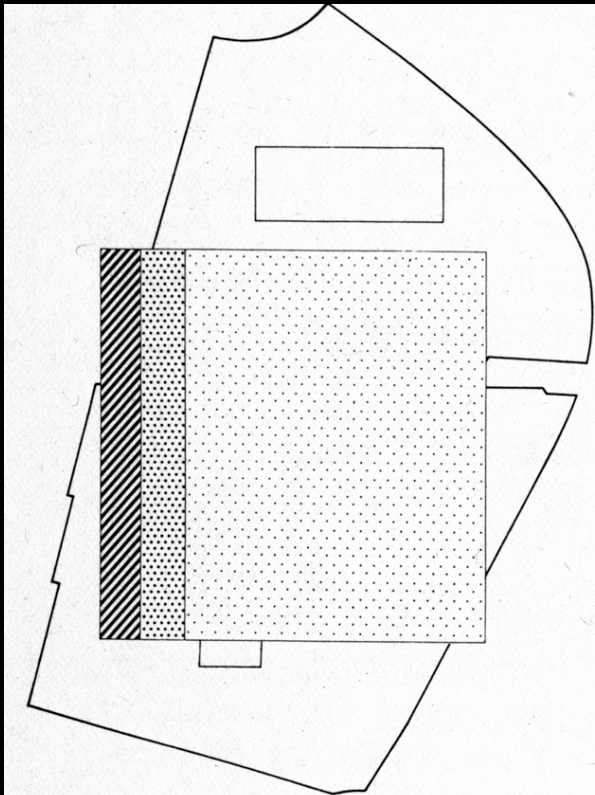

3

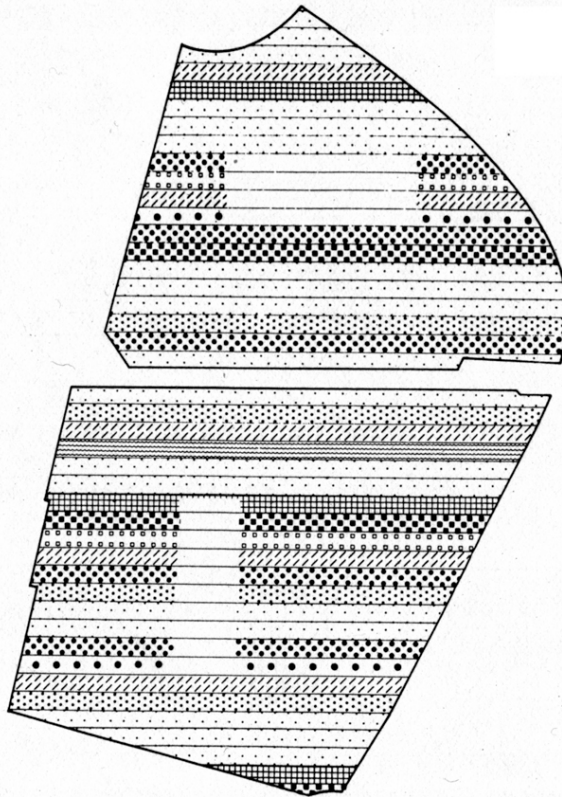

4

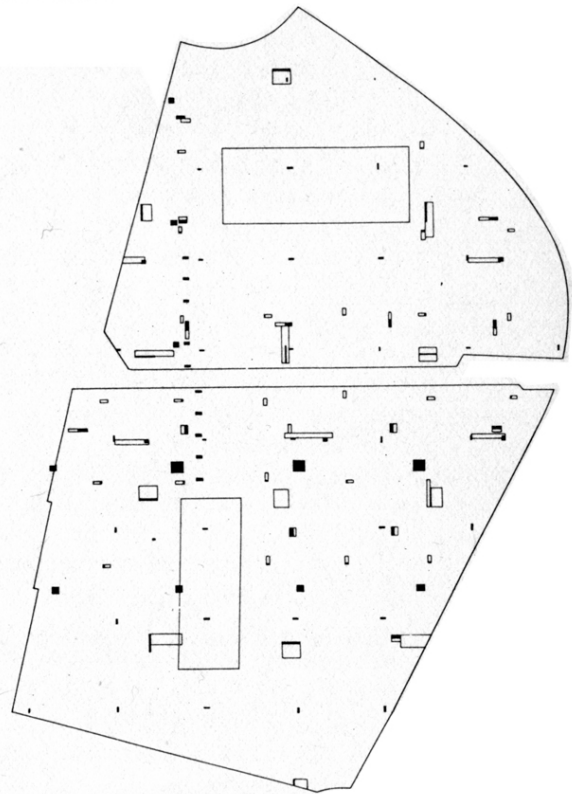

5

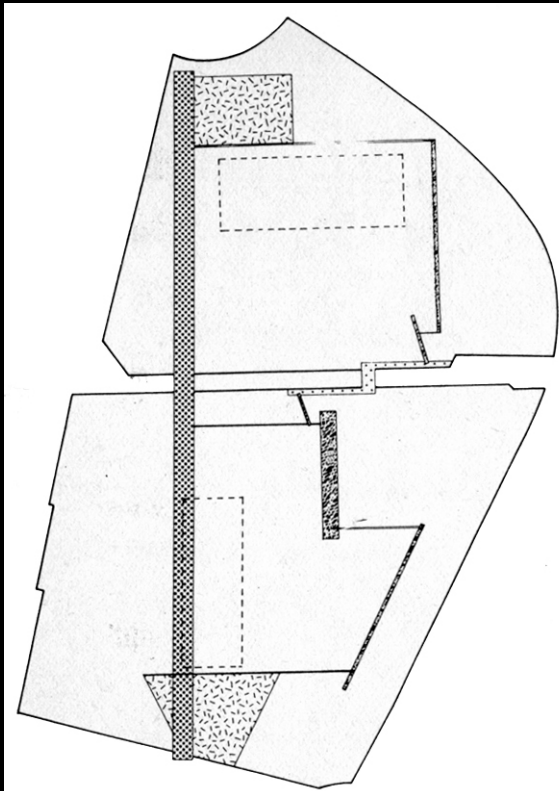

6

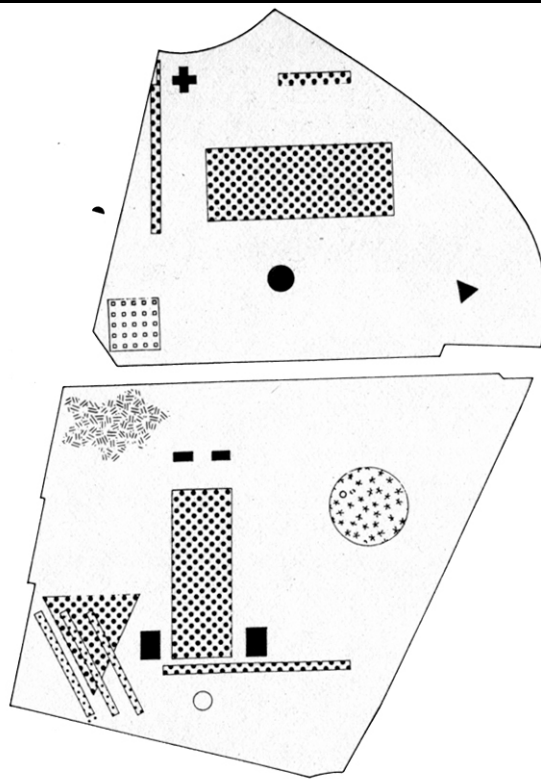

7

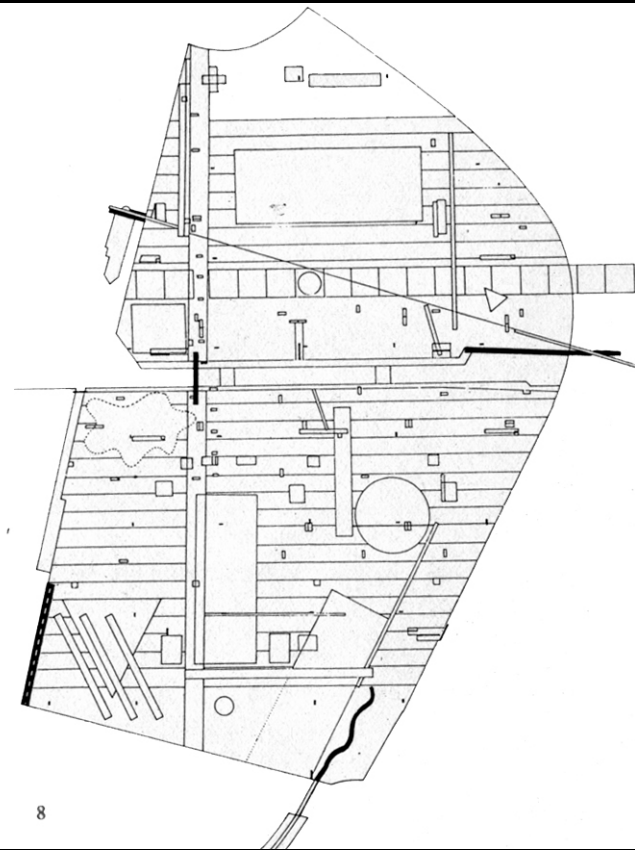

8

